



HECTOR FINCH

## BUBBLE GLASS WALL LIGHT



PRODUCT CODE WL21

CATEGORY: WALL LIGHTS

### DIMENSIONS

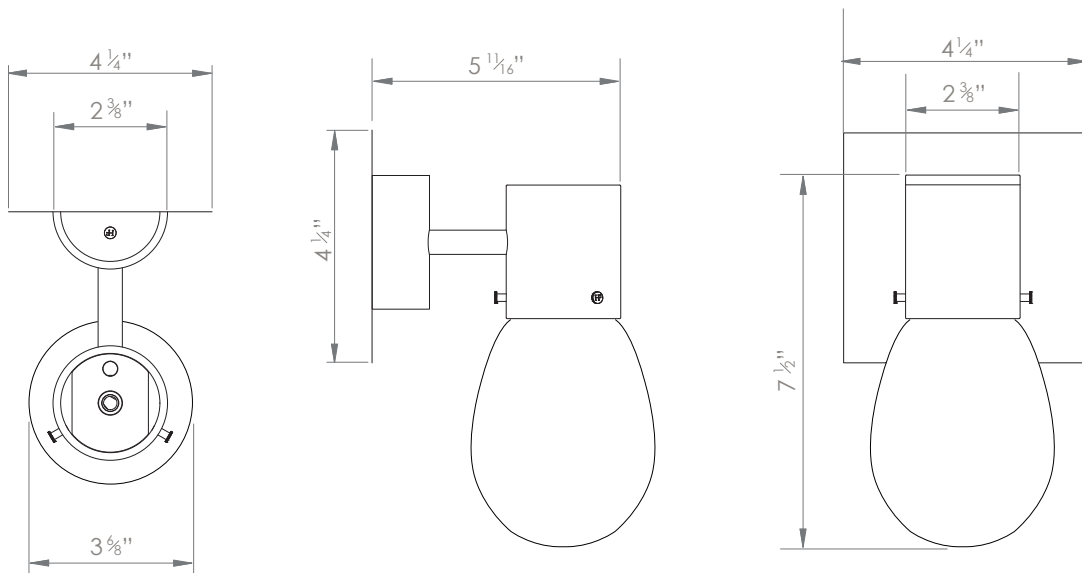



HECTOR FINCH

PRODUCT CODE WL21

CATEGORY: WALL LIGHTS

## BUBBLE GLASS WALL LIGHT

LAMP TYPE	<b>USA</b> 1 x 25W (Max) E12 Pygmy Lamp
FINISH OPTIONS	Brass Polished Lacquered, Brass Polished Unlacquered (shown), Antique Brass, Bronze, Chrome, Nickel Polished and Nickel Matte.
SIZE & SIMILAR OPTIONS	Bubble Glass Pendant (PL21).
WEIGHT	5lb 5oz
MOUNTING	Our wall lights are designed to fit a standard US j-box with mounting holes 3 5/16" apart.
CLEANING AND MAINTENANCE INSTRUCTIONS	<p>Metalwork:</p> <p>We recommend a light polish with a non-abrasive lint free cloth. Do not use any metal cleaning products on the fixture as it can remove the finish entirely. Unlacquered brass finish will patinate slowly over time and can be brightened to brass by the use of a brass cleaning agent.</p> <p>Glass:</p> <p>Remove the glass where it is safe to do so. The glass then can be cleaned with a glass cleaner and a lint free cloth. Do not spray glass cleaner directly on the glass or fixture as it could affect the metal finish. Ensure the light is switched off and take care not to pull the flex or allow water to come into contact with the electrical components. Regular dusting with a feather duster will also help keep the glass clean.</p>