



HECTOR FINCH

GUINEVERE WALL LIGHT DOUBLE



PRODUCT CODE WL307

CATEGORY: WALL LIGHTS

DIMENSIONS

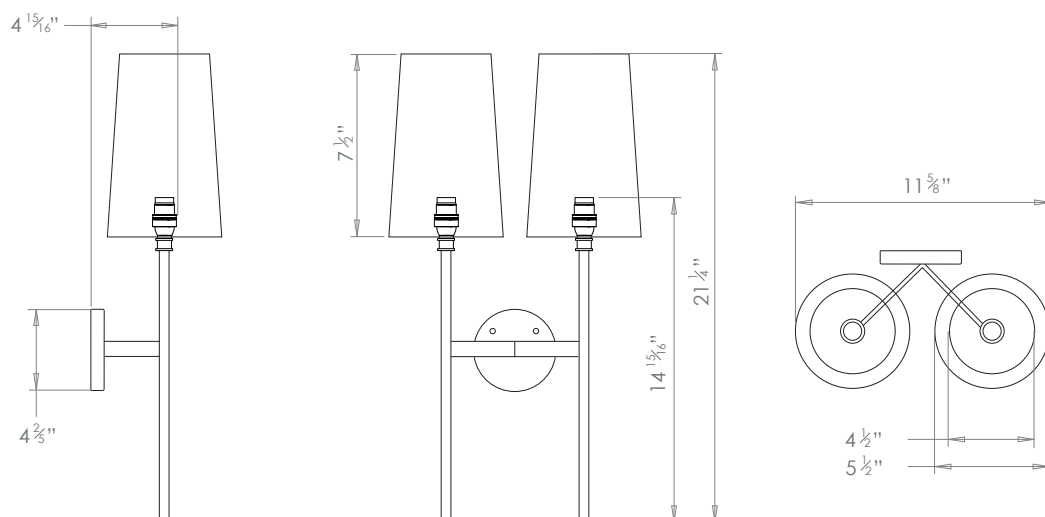



HECTOR FINCH

PRODUCT CODE WL307

CATEGORY: WALL LIGHTS

GUINEVERE WALL LIGHT DOUBLE

LAMP TYPE	USA 2 x 60W (Max) E26 General Service
SHADE OPTIONS	USA Shade 22 (5 ½" base X 4" top X 7 ½" height).
FINISH OPTIONS	Brass Polished Lacquered, Brass Polished Unlacquered, Antique Brass, Bronze, Chrome, Nickel Polished (shown) and Nickel Matte.
SIZE & SIMILAR OPTIONS	Guinevere Wall Light (WL306), Guinevere Chandelier (CH72) and Elsa Wall Light (WL29).
WEIGHT	3lb 1oz
ACCREDITATION	This product is UL certificated. 
MOUNTING	Our wall lights are designed to fit a standard US j-box with mounting holes 3 5/16" apart.
ADDITIONAL INFORMATION	Shade not included.
CLEANING AND MAINTENANCE INSTRUCTIONS	<p>Metalwork:</p> <p>We recommend a light polish with a non-abrasive lint free cloth. Do not use any metal cleaning products on the fixture as it can remove the finish entirely. Unlacquered brass finish will patinate slowly over time and can be brightened to brass by the use of a brass cleaning agent.</p> <p>Fabric Shades:</p> <p>Wipe gently with a dry cloth or dust lightly with a feather duster. Repeat regularly to prevent the build up of dust. Regular cleaning will prevent the possibility of dust becoming ingrained. Do not let water or moisture come into contact with the shade.</p>