



HECTOR FINCH

## REED WALL LIGHT



PRODUCT CODE WL312

CATEGORY: WALL LIGHTS

### DIMENSIONS

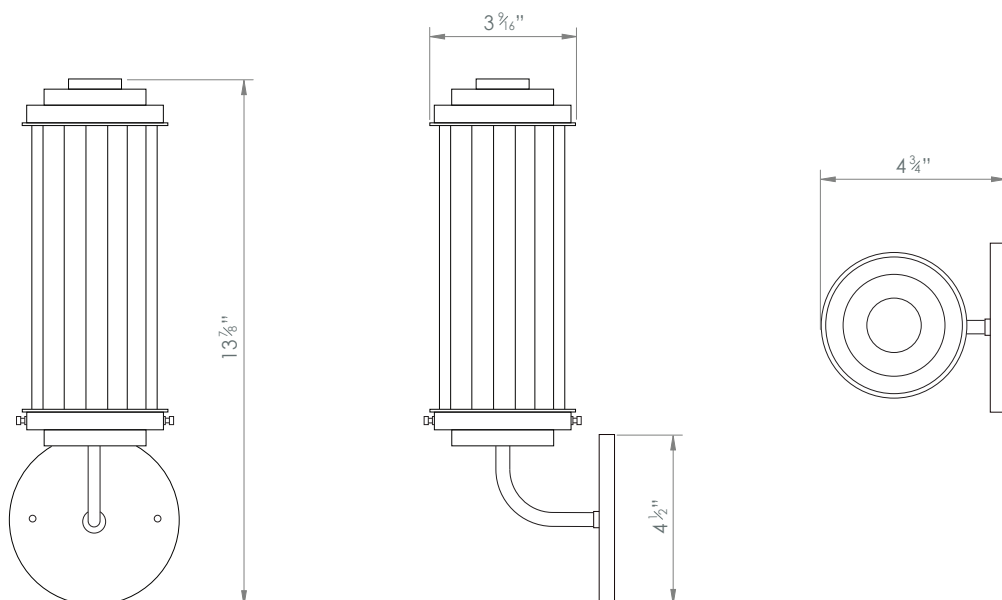



HECTOR FINCH

PRODUCT CODE WL312

CATEGORY: WALL LIGHTS

## REED WALL LIGHT

LAMP TYPE	<b>USA</b> 1 x 60W (Max) E26 Golfball
FINISH OPTIONS	Brass Polished Lacquered, Brass Polished Unlacquered, Antique Brass, Bronze, Chrome, Nickel Polished (shown) and Nickel Matte.
SIZE & SIMILAR OPTIONS	Bastion Wall Light (WL260) and Reed Pendant (PL146).
WEIGHT	3lb 16oz
CLEANING AND MAINTENANCE INSTRUCTIONS	<p>Metalwork: We recommend a light polish with a non-abrasive lint free cloth. Do not use any metal cleaning products on the fixture as it can remove the finish entirely. Unlacquered brass finish will patinate slowly over time and can be brightened to brass by the use of a brass cleaning agent.</p> <p>Ceramic: The ceramic components can be cleaned with a light spray of water and a lint free cloth. Ensure the light is switched off and take care not to pull the flex or allow water to come into contact on the electrical components.</p>