



HECTOR FINCH

DIDO WALL LIGHT MINI



PRODUCT CODE WL471

CATEGORY: WALL LIGHTS

DIMENSIONS

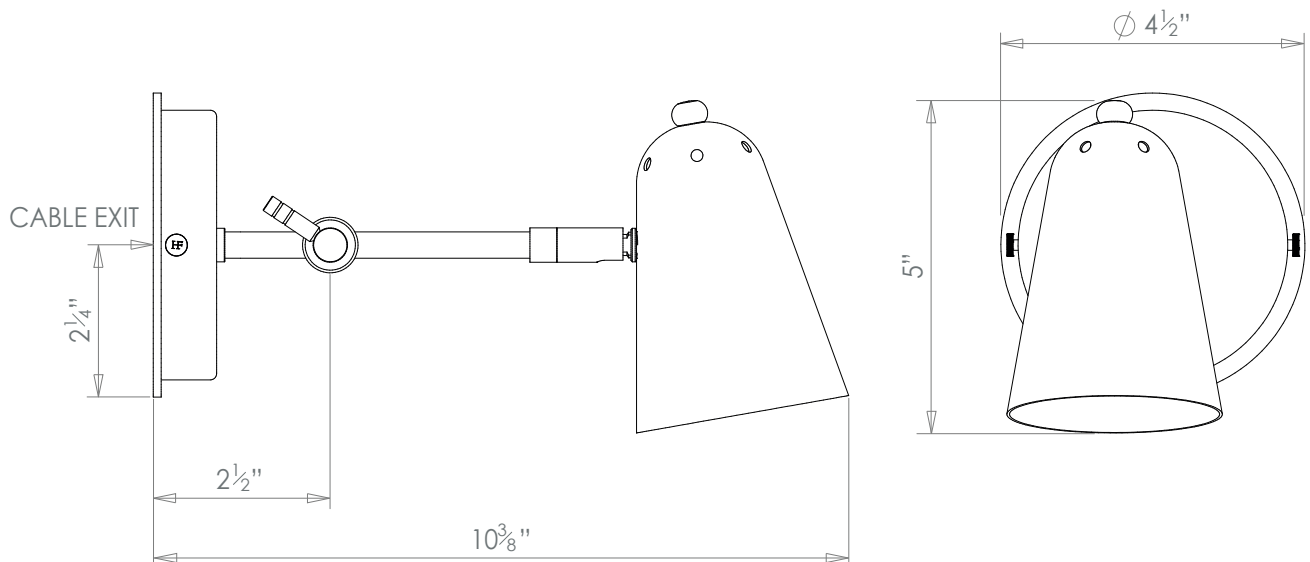



HECTOR FINCH

PRODUCT CODE WL471

CATEGORY: WALL LIGHTS

DIDO WALL LIGHT MINI

| | |
|---------------------------------------|---|
| LAMP TYPE | USA 1 x 5W (Max) GU10 LED |
| FINISH OPTIONS | Brass Polished Lacquered, Brass Polished Unlacquered, Antique Brass (shown), Bronze, Chrome, Nickel Polished and Nickel Matte. |
| SIZE & SIMILAR OPTIONS | Dido Single Arm Wall Light (WL462), Dido Single Arm Wall Light with Switch (WL462SW), Dido Double Arm Wall Light (WL461), Dido Double Arm Wall Light with Switch (WL461SW) and Dido Table Lamp (TL116) |
| WEIGHT | 1lb 2oz |
| MOUNTING | Our wall lights are designed to fit a standard US j-box with mounting holes 3 5/16" apart. |
| ADDITIONAL INFORMATION | Supplied with a GU10 LED bulb, 5W, 2700k Warm White. Dimmable GU10 bulbs can be sourced online or at a local hardware store. |
| CLEANING AND MAINTENANCE INSTRUCTIONS | Metalwork: We recommend a light polish with a non-abrasive lint free cloth. Do not use any metal cleaning products on the fixture as it can remove the finish entirely. Unlacquered brass finish will patinate slowly over time and can be brightened to brass by the use of a brass cleaning agent. |