



THERMACELL®

LIV™

Smart Mosquito
Repellent System

INSTALLATION GUIDE

Important Safety Information

⚠ WARNING: To reduce the risk of injury or damage, read and follow the safety precautions when setting up, using and maintaining your mosquito repellent system.

SAVE THESE INSTRUCTIONS

⚠ WARNING: When using an electrical appliance, basic precautions should always be followed, including the following:

READ ALL INSTRUCTIONS

⚠ WARNING: To reduce the risk of injury or damage, read and follow the safety precautions when setting up, using and maintaining your mosquito repellent system.

⚠ This is the safety alert symbol. It is used to alert you to potential physical injury hazards. Obey all safety messages that follow this symbol to avoid possible injury or death.

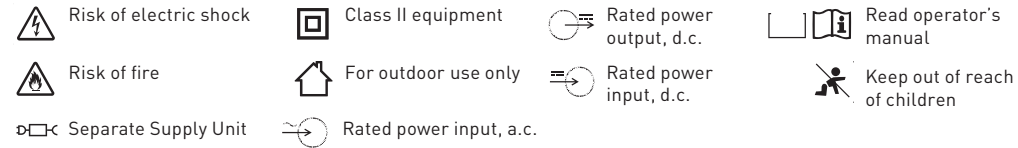

WARNING: Indicates a hazardous situation that, if not avoided, could result in death or serious injury.

CAUTION: Indicates a hazardous situation that, if not avoided, could result in minor or moderate injury.

NOTICE: Indicates a hazardous situation that, if not avoided, could result in property damage.

⚠ WARNING

- Your mosquito repellent system is not a toy. Small children and pets should be supervised when your system is operating.
- Do not sit or stand on repellents or smart hub.
- This appliance is not intended for use by persons (including children) with reduced physical, sensory or mental capabilities, or lack of experience and knowledge, unless they have been given supervision or instruction concerning use of the appliance by a person responsible for their safety.
- Your smart hub comes with a region approved power supply cord. and is designed to be plugged into an outdoor GFCI power outlet only. Do not use any other power supply cord. If the supply cord is damaged, it must be replaced by the manufacturer, its service agent or similarly qualified persons in order to avoid a hazard.
- Do not open your smart hub or repellents, except to change cartridges.
- There are no user serviceable parts inside. Refer servicing to qualified service personnel.
- Risk of electric shock, do not use with extension cords or power strips.
- Store your repellent cartridges away from children and pets in dry, room temperature environments only.

⚠ CAUTION

- If connecting cables are exposed, there is a chance that it will be a trip hazard, or exposed to sharp object such as lawnmowers. Before using this device, ensure that all cables are tucked out of the way, or buried under grass or mulch.

NOTICE

- This product is intended for outdoor use only. Do not use this device indoors. Do not allow your repellents to initialize indoors
- Do not place anything on top of your repellents.
- The failure to maintain cleanliness of repellents and smart hub could result in diminished ability to perform as designed.

SYSTEM COMPONENTS

Smart Hub

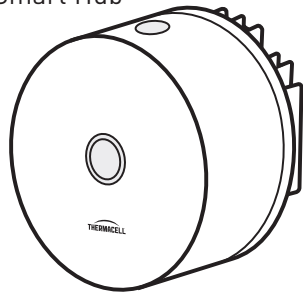

Repellers

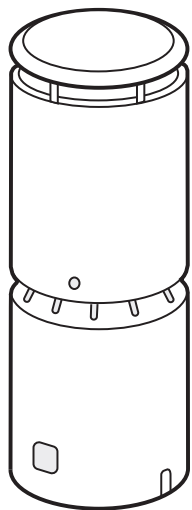

Connecting Cables

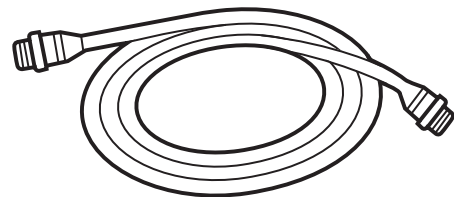

Standard Mount

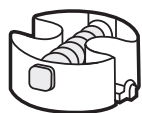

Hub Mounting Screws



Repeller Key

Ground Stakes

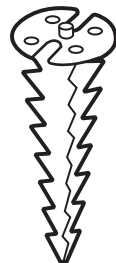

WHAT YOU NEED

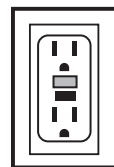

Outdoor GFCI Outlet
(with wi-fi near by)

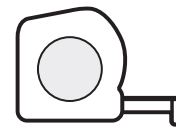

Tape Measure



Phillips Head
Screwdriver

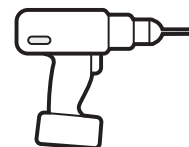

Drill with 1/8" bit



Standard
Deck Screws
(If installing
repellers onto deck)

SOLD SEPARATELY

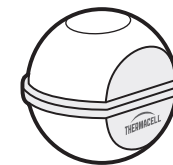

Repellent Cartridges

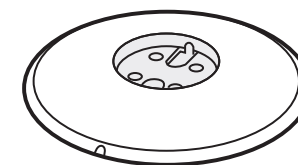

Hardscape Bases

If using the LIV+ app:



Wi-fi (and password)

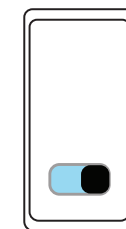

Smartphone with iOS 11.0
or later, Android 8.0 or later

Let's get started!

Just follow the step-by-step instructions and remember — we're always here to answer any questions.

HOW IT WORKS

LIV uses a Smart Hub to power a series of on-demand repellents installed throughout your outdoor space. When turned on, each repeller continually releases repellent to provide complete area protection from mosquitoes and other flying insects, when and where you need it.

With the LIV+ app, you can control your system from anywhere, set schedules and timers, and more.

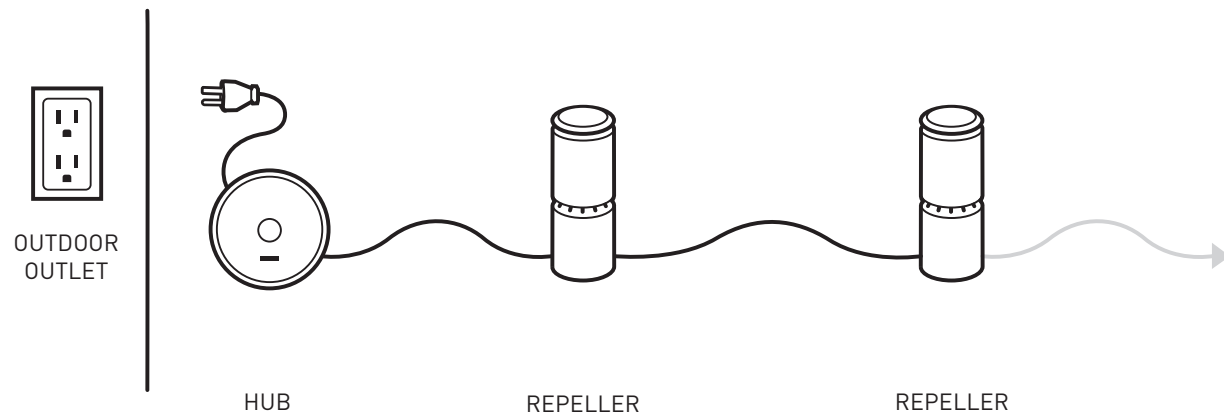

Identify areas you use the most and want to feel protection from mosquitoes. e.g., perimeter around an entire patio, or important areas like the grill, seating area, playground, etc.

The repellents should be placed near those areas, within 10 feet of the zones you want to protect, and for continuous protection, up to 20 feet apart from each other.

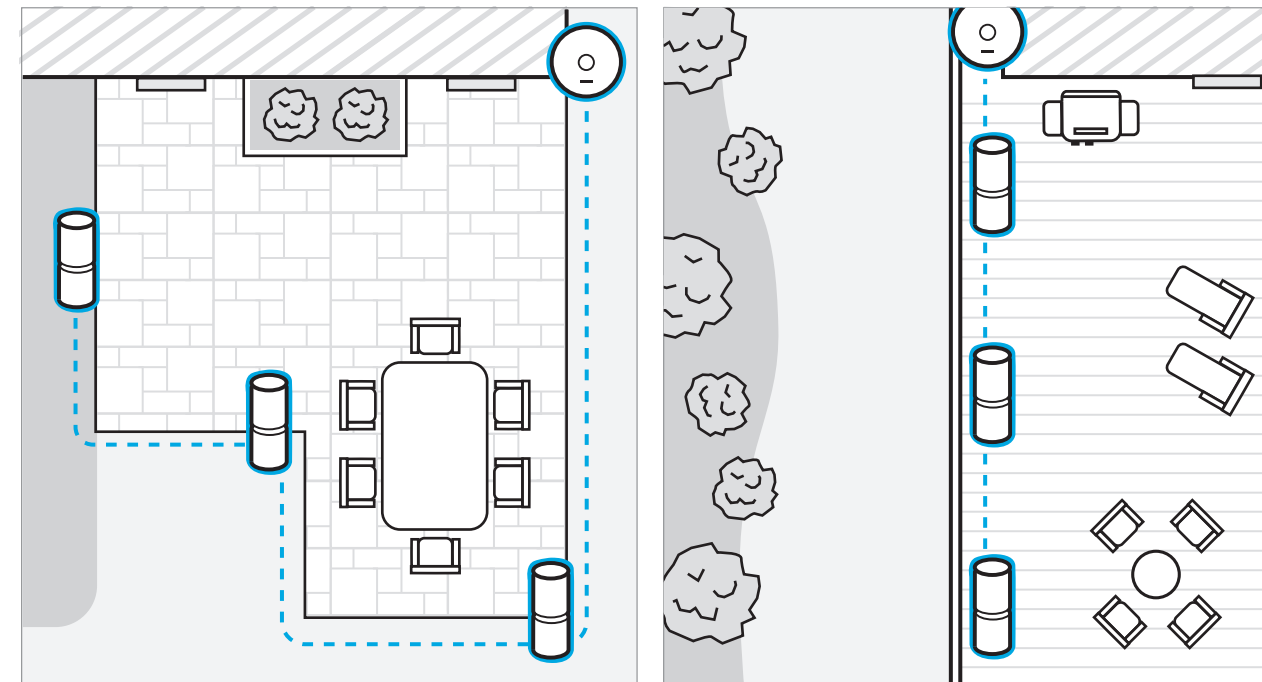

1

MAP IT OUT

Feeling inspired? Use the grid below to map your install. Consider outlet location, repeller placement and mounting preference, and cable pathways.

Note: Repellers provide 360 degrees of protection; for best results, place a repeller within 10 feet of the areas most commonly used, like patio chairs, grills, tables, walkways, etc. For continuous area protection, space repellers 20 feet apart.

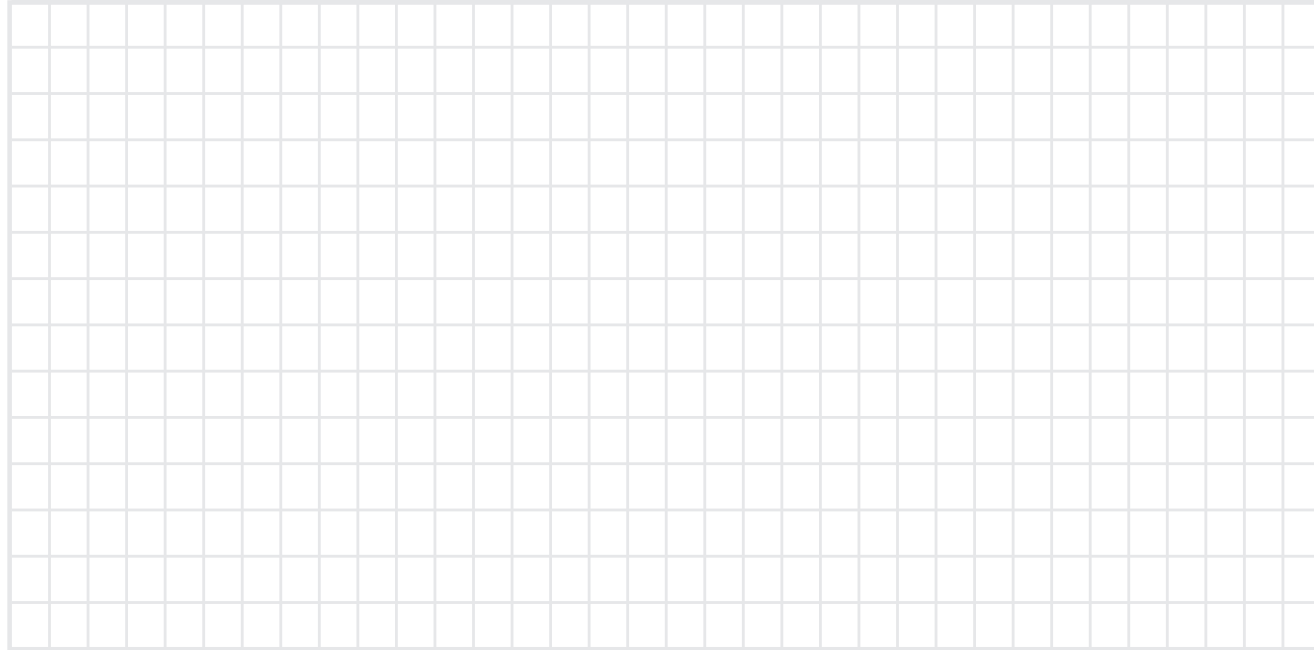

2

MOUNT THE HUB

The Smart Hub should be located near an outdoor outlet in an area with strong Wi-Fi signal. Check Wi-Fi signal on your phone before installing any components. Once adequate signal is confirmed, prepare to mount the hub to a wall, post, or stake no more than 6 feet from the power outlet and at least 30 inches off the ground to avoid exposure to water and snow. Use the template provided to drill the 2 mounting screws and hang the hub in place.

Note: If mounting onto brick or other masonry, concrete anchors and an appropriate drill bit will be required.

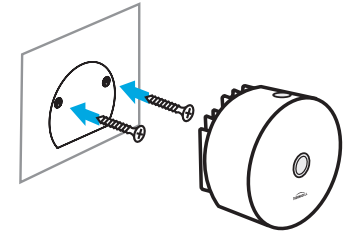

3

LAY IT ALL OUT

Lay each repeller according to your plan outlined in Step 1. Lay the cables between repellers to ensure you have enough cable length to route around any obstacles.

4 MOUNT THE REPELLERS

Depending on your installation and selected hardware, follow the appropriate step below to attach repeller.

Use the Standard Mount to install directly to a firm surface.

Hold the mount in place and mark the hole locations. Pre-drill at least two holes and attach the mount with standard deck screws*. Pass the cable through the cutouts and install the repeller onto the mount by squeezing the quick-connect tabs.

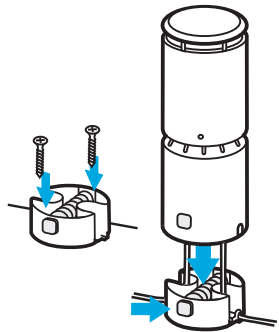

Use a Ground Stake on soft ground like grass or mulch.

To install, press the stake into the ground until it is flush or just above ground level. Twist on the standard mount. Pass the cable through the cutouts, and attach the repeller by squeezing the quick-connect tabs.

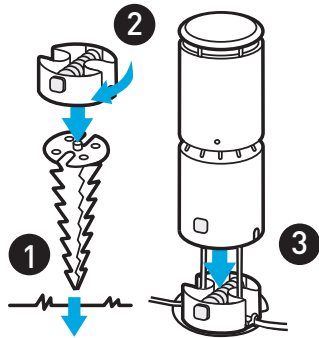

Use a Hardscape Base on stone, paver, decking, or other hard surfaces where drilling is not desired.

To install, thread the standard mount to the base until secure. Pass the leads from the repeller through the center of the base and install the repeller by squeezing the quick-connect tabs. Route the pigtail connectors on the underside of the base so they sit in the cutouts.

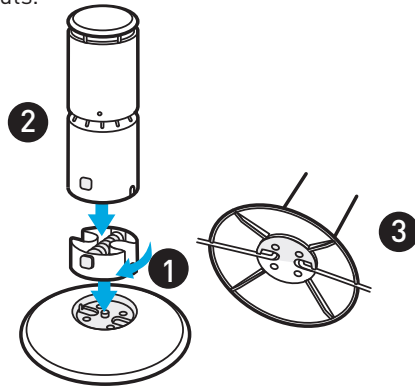

5 CONNECT THE CABLES

First, connect a cable to the smart hub. Remove the cap from the ends of cable leads on the first repeller. Connect the corresponding end of the first cable to the repeller. Connect each subsequent repeller in the same fashion. Leave the cap plug on the remaining cable pigtail of the final repeller in the chain.

Note: The connectors should be threaded finger tight — do not over-tighten.

Do not bend or attempt to stuff excess cable into the repeller base.

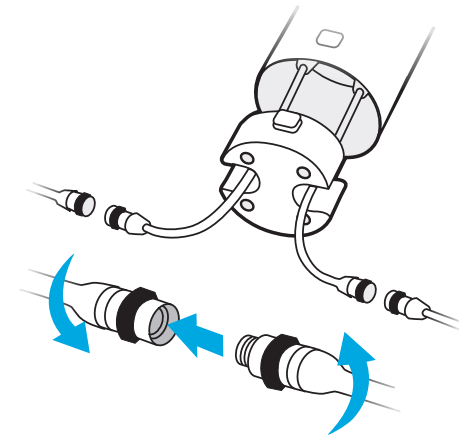

*Not included

6 TEST YOUR SYSTEM

Plug in the hub and check the underside: the Status LED should be blinking blue if connected to power. Press the center power button and make sure the ring around the button illuminates. Check each repeller to confirm the lights begin to flash in a chasing pattern. Within 5 minutes, the lights should change to solid blue.

Turn off the system by pressing the power button. Continue with final installation of cables.

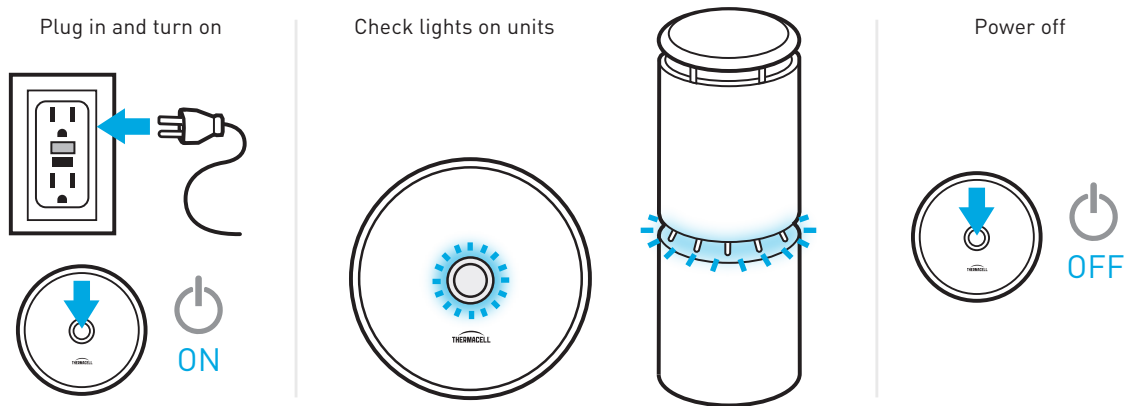

7 SECURE THE CABLES

Finish your installation by routing and securing your cables to prevent damage, avoid tripping hazards, and provide a professional installed appearance.

Common installation methods include:

Burial

Use a shovel/edging tool to create a 1-2 inch deep trench, lay the cable and cover with dirt.



Run Above Ground

Tuck the cable along edges of decking or pathways; or secure it with landscape staples or cable hooks.

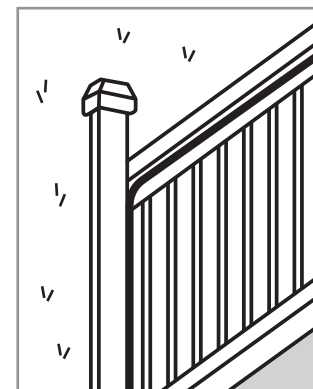

Cover with Mulch

Cover the cable with at least 2 inches of mulch.

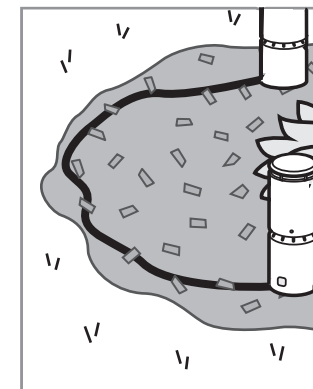

*Be sure to locate any pipes, cables, irrigation, or gas lines prior to digging in your yard. Call Dig Safe before you dig.

8 INSERT THE REPELLENT CARTRIDGES

Remove the hood from the repeller by twisting it 1/4 turn counter-clockwise.

Open a repellent cartridge by twisting the blue top counter-clockwise. Do not touch the wick.

Align the tabs on the cartridge with the tabs on the repeller. Slide the cartridge up into place until you feel it click. Replace the repellent hood.

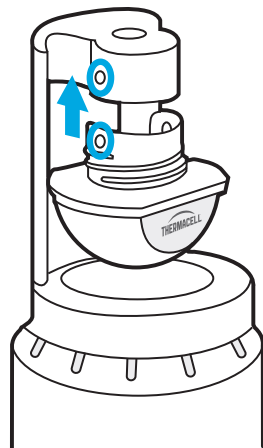
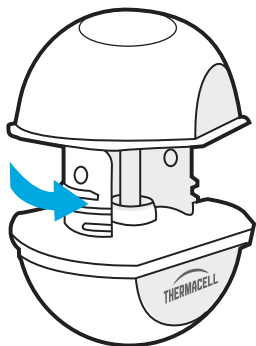
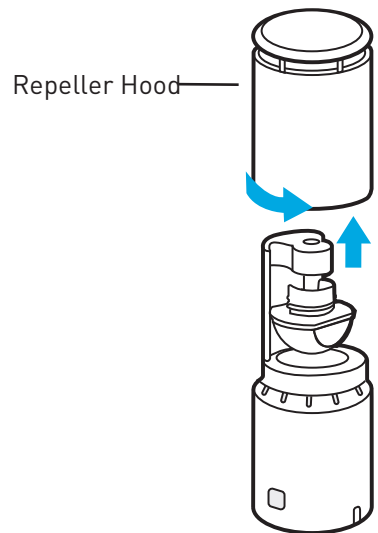

*Note: The repeller has a set screw at the bottom of the repellent hood which can be used to lock the hood to the repeller and prevent unintended access to a cartridge. Use a 1.5mm allen wrench to back out the screw just enough to lock in place.

9 DOWNLOAD THE APP

Get the most out of your system by downloading the LIV+ app. The app lets you connect your system to your home's Wi-Fi network and then control your system from almost anywhere, schedule automatic on and off times, customize the repeller lights and more. Connect with your smart home system to use voice commands.

