



XONAR[®]

TruePort[™]

Specification Sheet

TruePort™

Specification Sheet

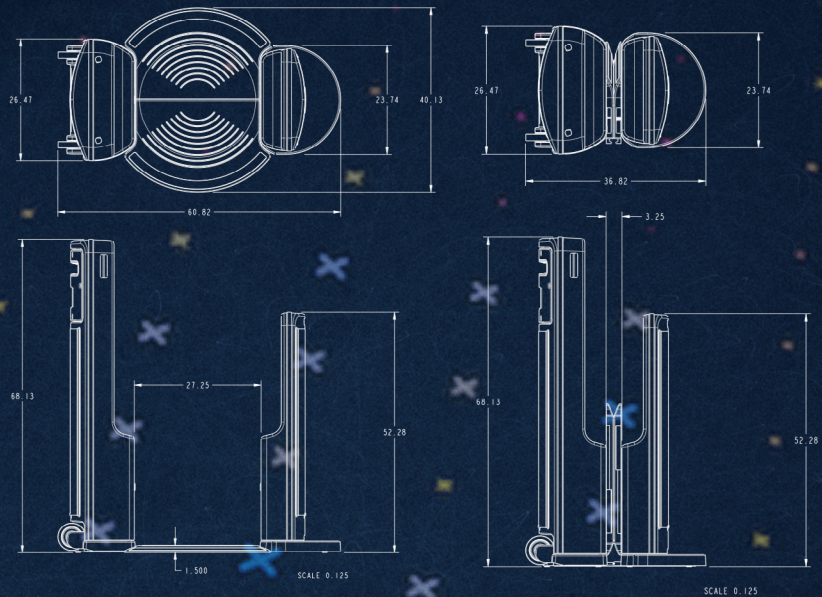

Feature Highlights

- **Highly Portable & Set-Up Time in Under 5 Minutes:** TruePort™ features built-in wheels and folding/unfolding capabilities, allowing it to be easily transported and set up in under 5 minutes with a boot-up time of less than 2 minutes.
- **Small Footprint:** TruePort™ units have a minimal footprint of 5 feet and can be set up back to back with no space needed in between units.
- **Detection Capabilities:** TruePort™ detects ferrous and non-ferrous metals as well as, non-metallic objects and even liquids.
- **A.I. Threat Decision Time:** TruePort™'s AI enables rapid threat scanning and detection within just 200 milliseconds.
- **High Throughput:** With high-throughput capabilities, TruePort™ ensures that security screening processes remain swift and seamless.

TruePort™

Specification Sheet

Environmental specifications

Operating temp/humidity

0°C to 50°C / 10-90% RH

Storage temp/humidity

-20°C to 70°C / 10-95% RH

Additional features

- Facial Recognition
- Custom advertising panels
- Software and AI model updates
- Customer Portal & Analytics
- Digital Ticketing Integration
- Wifi-enabled

Physical specifications

High Tower Depth	16.687 in
Low Tower Depth	17.375 in
High Tower Width	26.5 in
Low Tower Width	23.75 in
High Tower Height	71.5 in
Low Tower Height	52.4375 in
System Weight (no mat)	<200lbs
Floor Mat Weight	~40 lbs
Rated Voltage	100-240 VAC
Rated Frequency	50/60Hz
Max Power Consumption	<200Watts

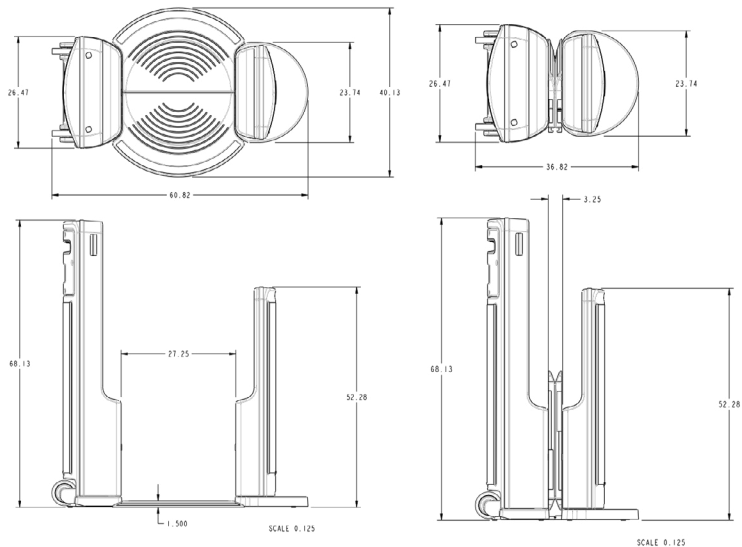

Questions?

DISTRIBUTED BY NOBLE

CONTACT

Edward M. Levy
 Director of Critical Infrastructure
 +1-203-564-6561
 elevy@noble.com