



WILLOW

1702 SQ FT

DETAILS

- Fortified Gold Standards Compliant
- Energy Star Compliant
- Green Building Standards Compliant
- High Density R-15 Bibs Wall Insulation
- Attic Insulation R-30 Fiberglass Loose Fill
- High Efficiency Vinyl Windows
- Energy Efficient Heating and Air
- Provides enhanced mitigation against flood due to elevation

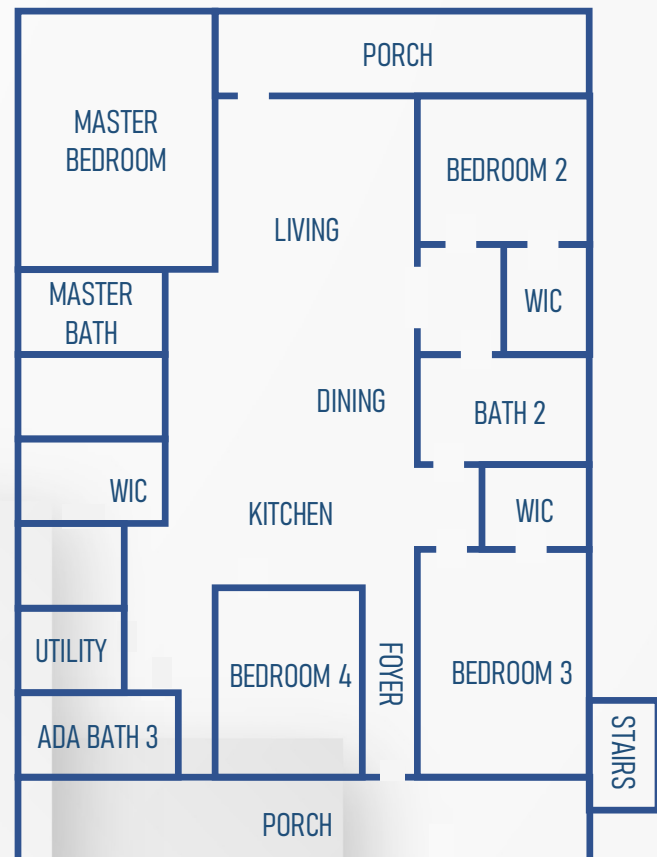

Floor plans are only conceptual renderings and final plans are subject to modifications as per program regulations. Landscaping is not included, shown for illustrative purposes only. All porch components shall be treated lumber with water sealer finish. Handrails shall consist of pressure treated spindles and pressure treated formed handrail. Lattice may be white vinyl or treated wood.