

ALUM. WINDWALL AVAILABLE INFILLS

Glass

ALUM. WINDWALLTM GLASS SCREEN SYSTEM

PRODUCT DATA



VIVA RAILINGS
LEADERS IN ARCHITECTURAL RAILING SYSTEMS

DESIGN + ENGINEER + FABRICATE + INSTALL

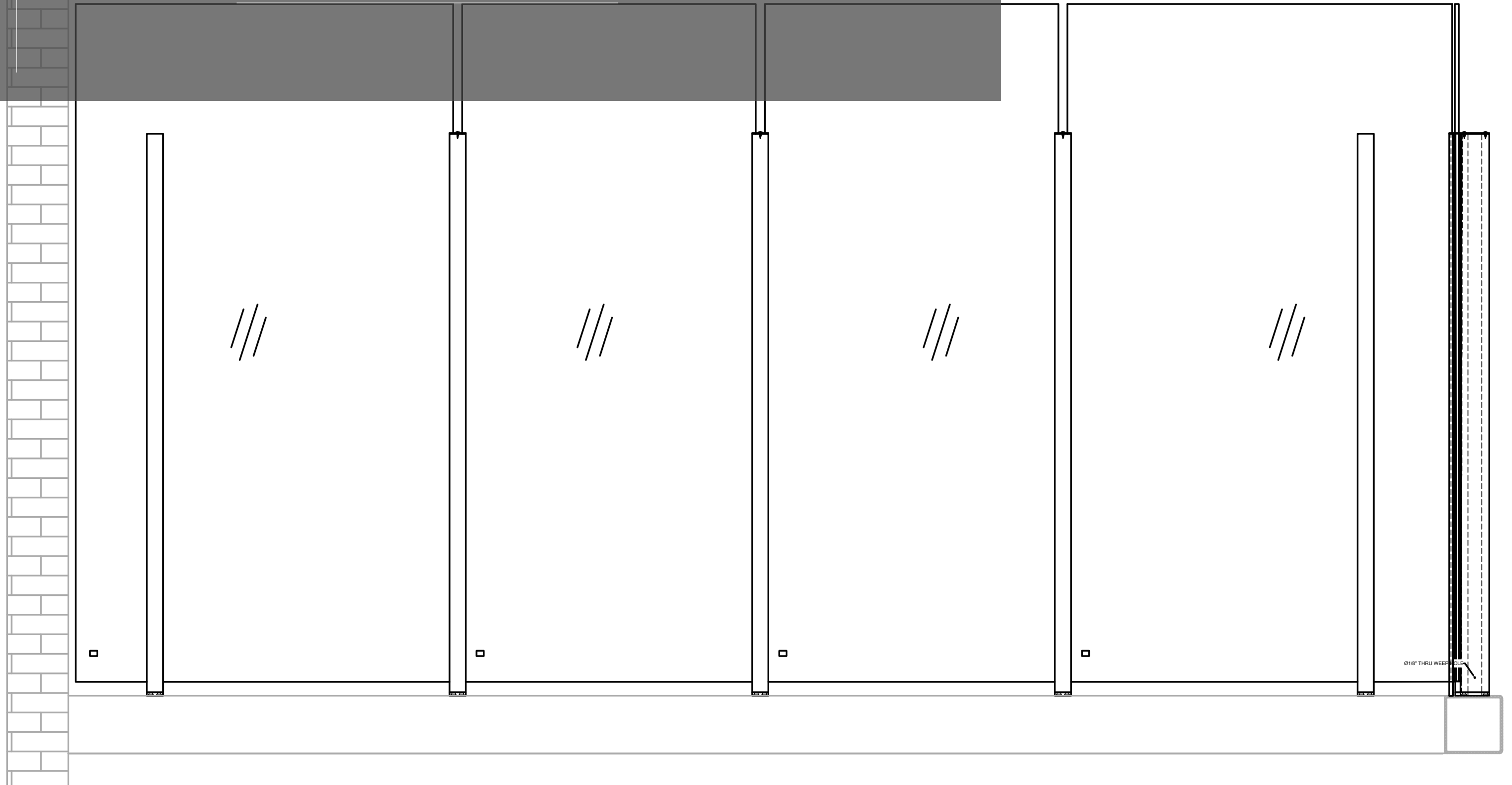

ALUM. WINDWALLTM GLASS SCREEN SYSTEM

ALUM. WINDWALL AVAILABLE INFILLS

Glass

The ALUM. WINDWALL system is an alternative addition to our SS WINDWALL system and is typically used at amenity deck levels in high-rise residential projects or by poolside.

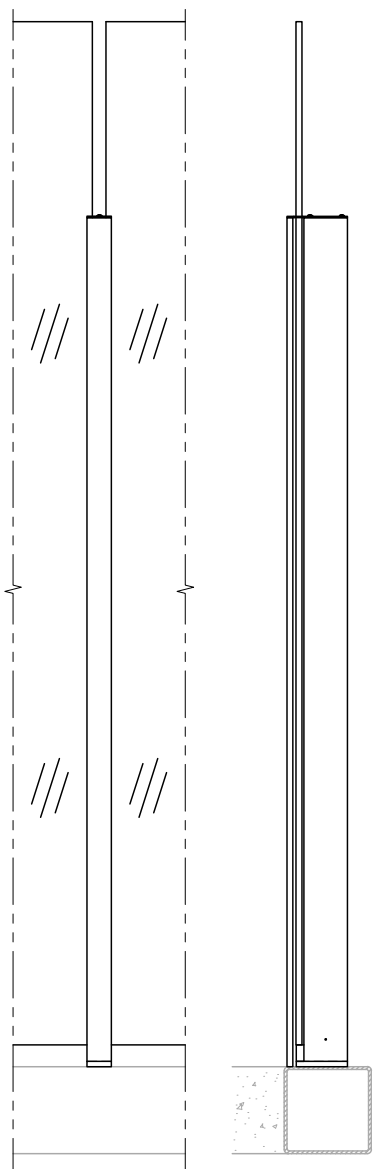

Other mounting options available.

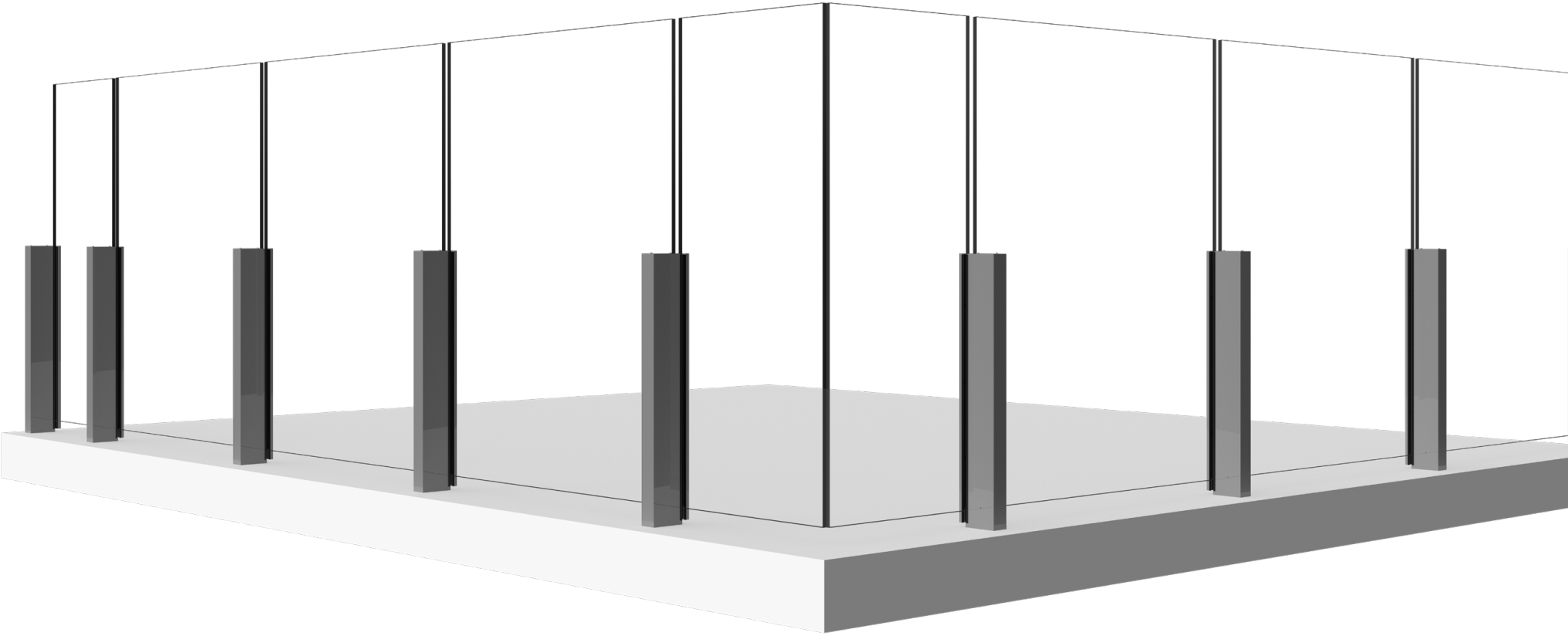

ALUM. WINDWALLTM GLASS SCREEN SYSTEM - TECHNICAL DATA

	MATERIAL	FINISH	SIZE/SPACING
POST	ALUM.	<div>Powder Coat Super Polyester (AAMA 2604) ²</div> <div>Powder Coat PVDF (AAMA 2605)</div>	2 1/4"x5 7/16" Square post @ 4'-0" max. O.C. 4'-0", 6'-0" & 8'-0" Height Alum. Windwall. Anchored, Cored or Welded mount.
INFILL	Glass	Clear, Tinted or Frit	Min. 1/2" laminated glass with SGP interlayer ¹ Glass standard thickness: 1/2", 5/8", 3/4" Interlayer standard thickness, SGP: 0.035" , 0.06"

FINISHING OPTIONS

Powder Coat*

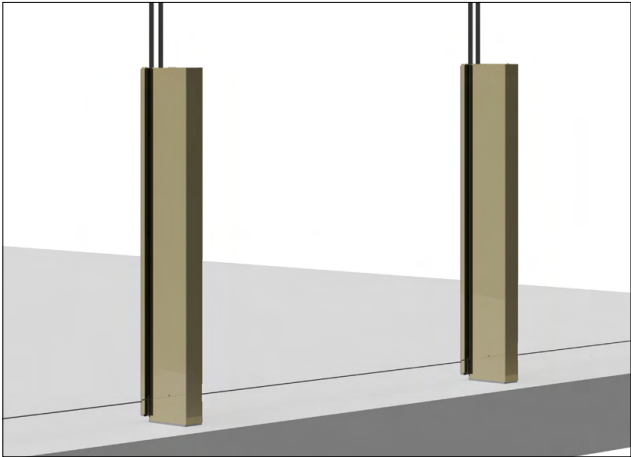

Powder coating is an environmentally-friendly option because it doesn't rely on solvents or chemical carriers. Instead, an electrostatic charge holds the paint to the steel, thus eliminating VOC emissions which will help in regards to LEED requirements. In addition, it meets AAMA specifications. Powder coating is durable and scratch resistant so it weathers and retains its original hue better than conventional liquid coatings.*

1. IBC 2015 & newer requires railing glass to be laminated. VIVA recommends SGP for exterior applications.
2. \$ to \$\$\$: indicates finish type comparative cost.

The digital swatches of our powder coat colors may not accurately represent the actual real-life samples. Factors such as monitor settings, lighting conditions, and individual perception can affect the colors you see on your screen. We suggest using the swatches as a general reference for color, shade, and hue, rather than expecting an exact match. For the most precise color selection, we recommend requesting physical samples or visiting our office in Lewisville, TX to evaluate the powder coat colors in person.

Please note that while we offer a diverse range of standard powder coat colors to complement our products, any selections outside of these standard options may incur additional costs. We encourage you to consult with our specialists to explore all available options and make the best decision for your project needs.



ALUM. WINDWALL GLASS SCREEN SYSTEM

4 FT. TALL GLASS

AVAILABLE GLASS TYPES



Clear Laminated (SGP)

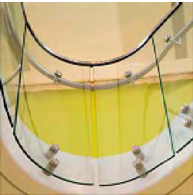

Bent

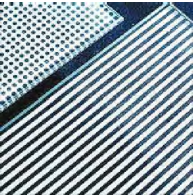

Ceramic Frit



Tinted



Satin Etched

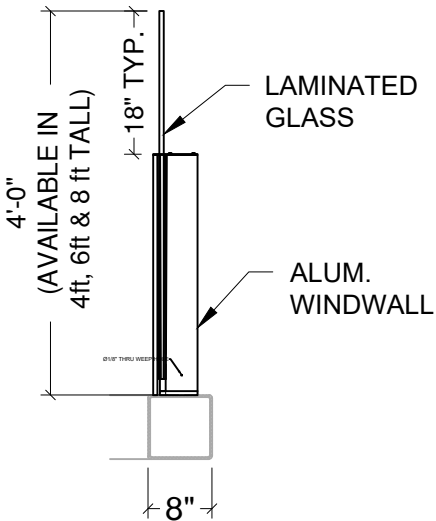
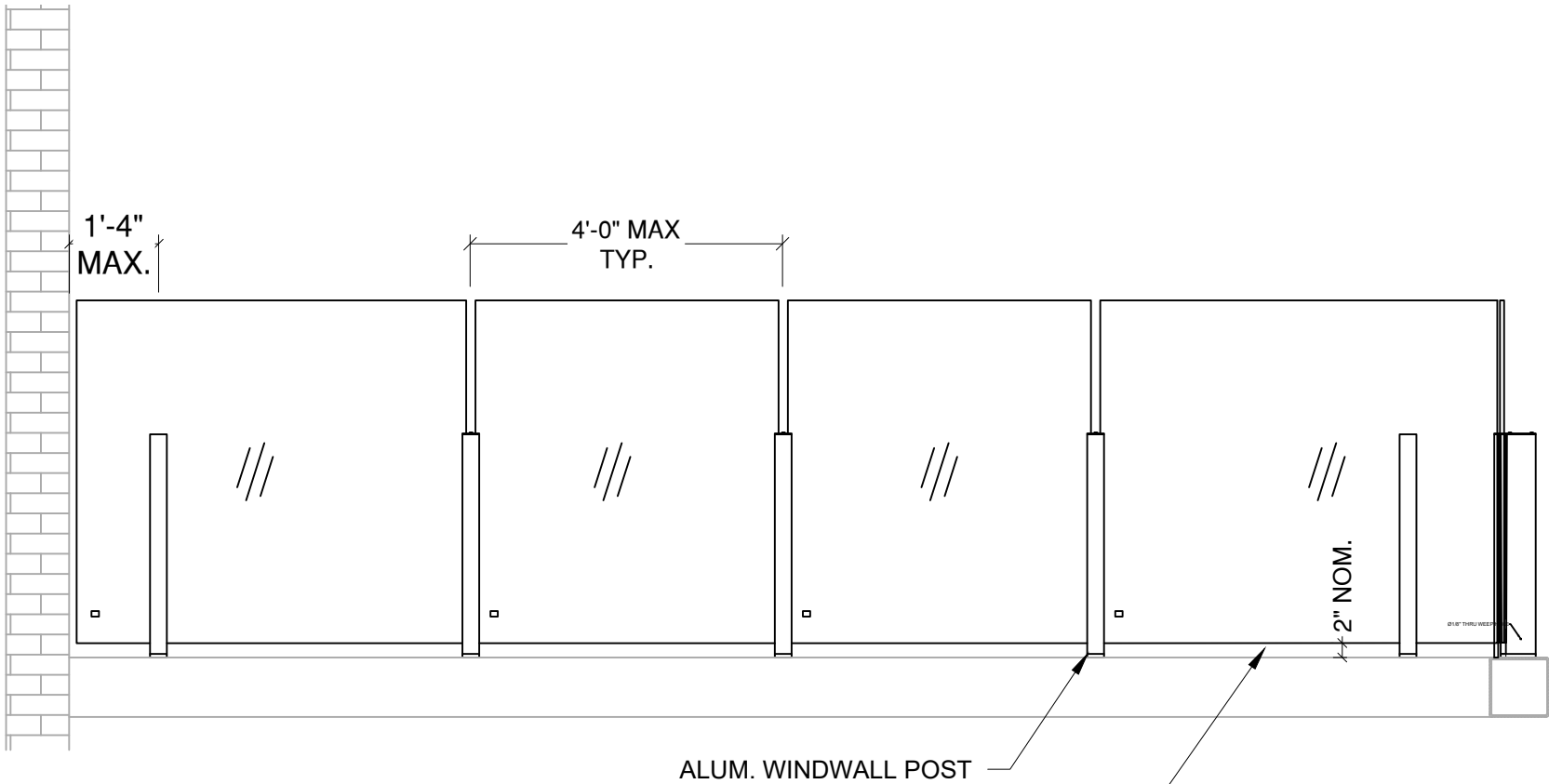
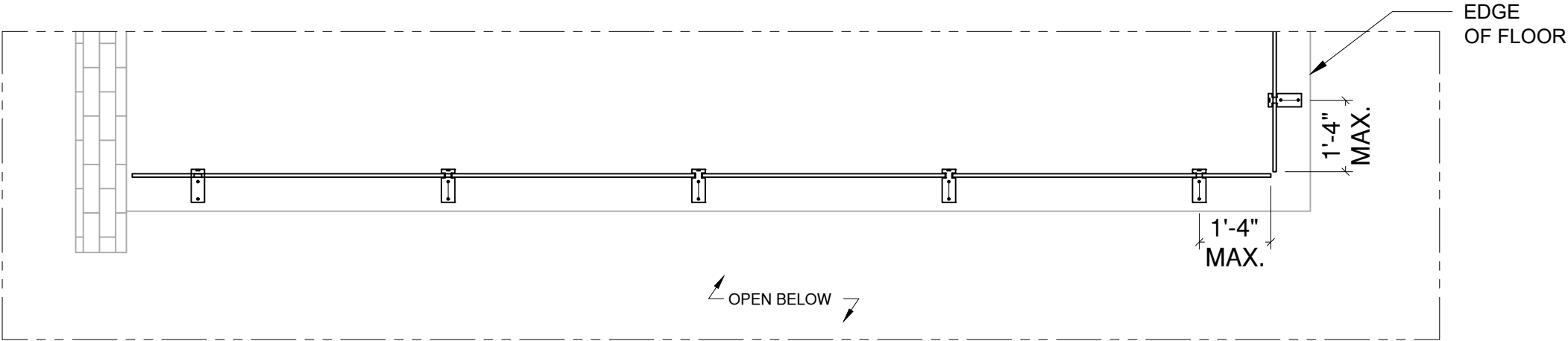

AVAILABLE IN GLASS THICKNESSES OF 1/2", 5/8" & 3/4" WITH CORRESPONDING POST HEIGHTS OPTIONS FOR VISIBILITY PREFERENCE. AS GLASS THICKNESS INCREASES, POST HEIGHT REDUCES AND COST INCREASES .

LAMINATED GLASS

VIVA RAILINGS IS NOT RESPONSIBLE FOR THE STRUCTURAL INTEGRITY OF ANY BUILDING SYSTEMS OR OTHER MATERIALS NOT FURNISHED BY VIVA RAILINGS. VIVA RAILINGS HAS NO WAY OF KNOWING AND SPECIFICALLY DISCLAIMS WHETHER OR NOT THE BUILDING SYSTEMS TO WHICH VIVA RAILINGS' PRODUCTS ARE TO BE ATTACHED ARE STRUCTURALLY SOUND OR DESIGNED TO PROPERLY SUPPORT VIVA RAILINGS'S MATERIALS. ANY SUCH DESIGN RESPONSIBILITY BELONGS TO OTHERS FOR WHOM VIVA RAILINGS IS NOT RESPONSIBLE. THESE DRAWINGS ARE INTENDED FOR THE SOLE USE OF VIVA RAILINGS' CUSTOMER AND THEIR AGENTS FOR THE INSTALLATION OF PRODUCTS FURNISHED BY VIVA RAILINGS. VIVA RAILINGS REMAINS THE SOLE OWNER OF ALL DESIGNS AND INTELLECTUAL PROPERTY CONTAINED WITHIN. REPRODUCTION AND USE OF THESE DESIGNS FOR ANY OTHER PURPOSE IS FORBIDDEN. SCALES ARE PROVIDED FOR REFERENCE ONLY. FOR PRODUCT INFORMATION AND TECHNICAL SUPPORT, PLEASE CONTACT VIVA RAILINGS.



ALUM. WINDWALL GLASS SCREEN SYSTEM

6 FT. TALL GLASS

AVAILABLE GLASS TYPES



Clear Laminated (SGP)

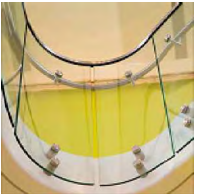

Bent

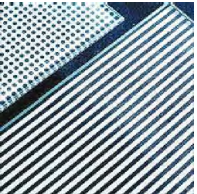

Ceramic Frit



Tinted



Satin Etched

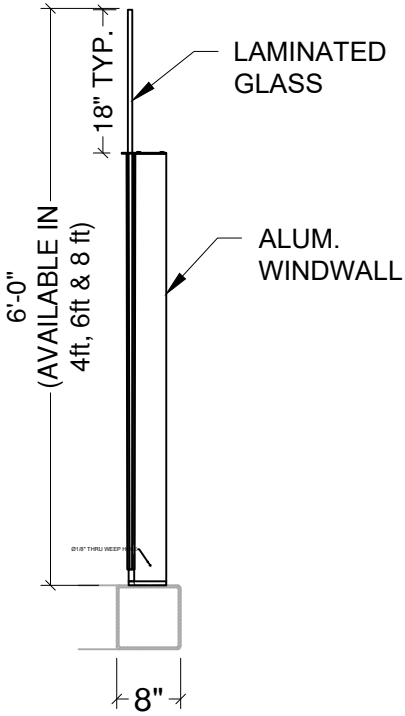
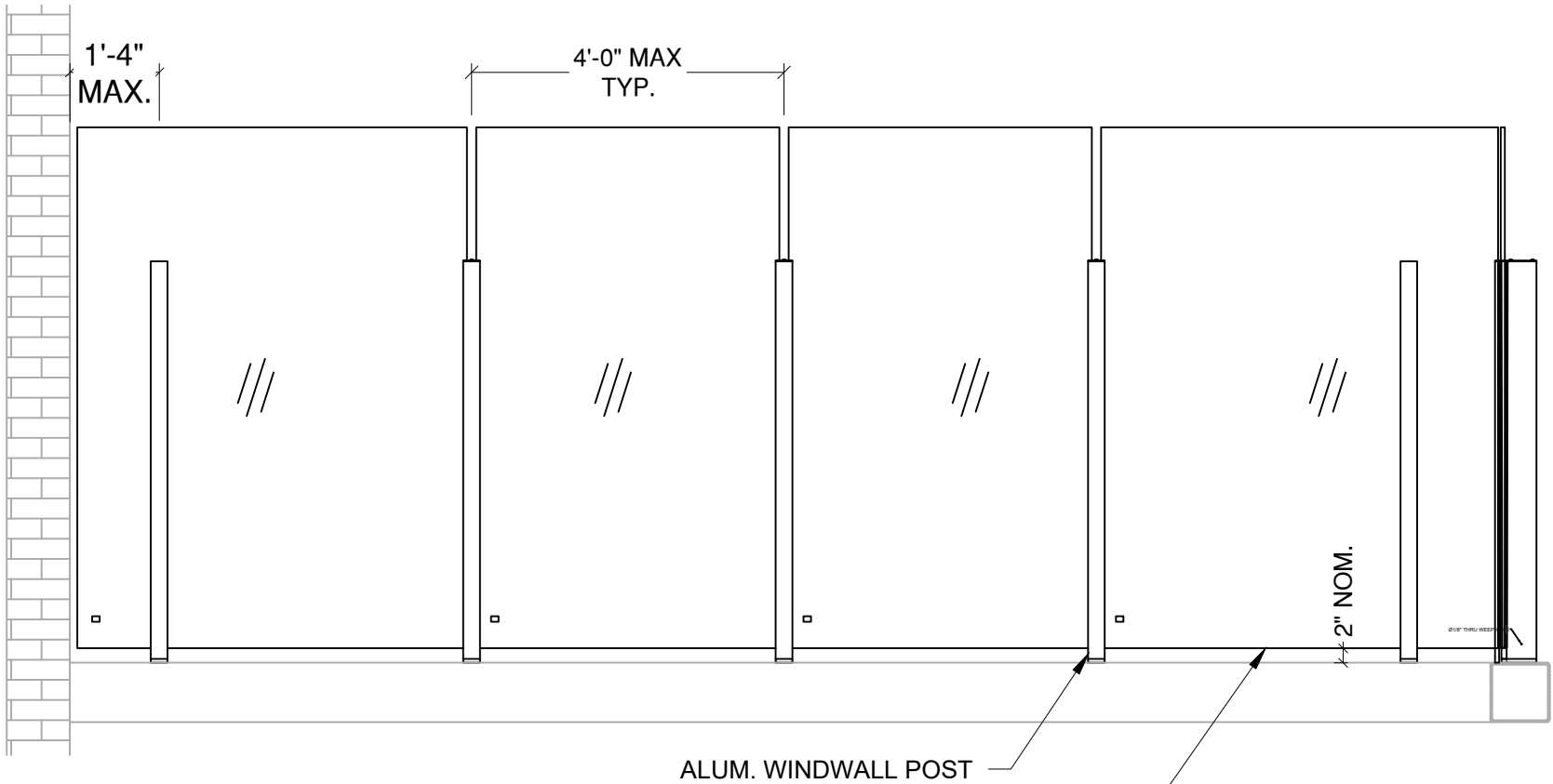
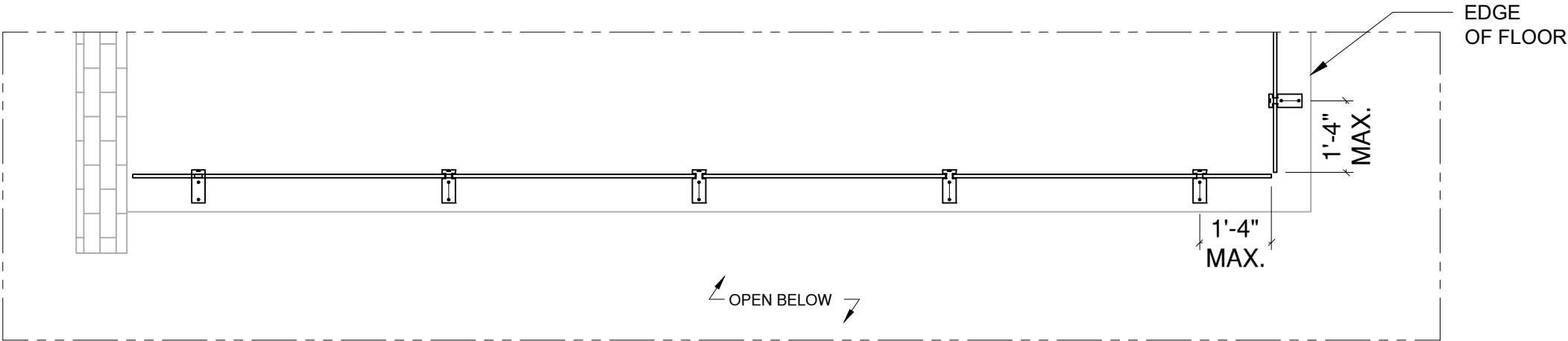

AVAILABLE IN GLASS THICKNESSES OF 1/2", 5/8" & 3/4" WITH CORRESPONDING POST HEIGHTS OPTIONS FOR VISIBILITY PREFERENCE. AS GLASS THICKNESS INCREASES, POST HEIGHT REDUCES AND COST INCREASES .

VIVA RAILINGS IS NOT RESPONSIBLE FOR THE STRUCTURAL INTEGRITY OF ANY BUILDING SYSTEMS OR OTHER MATERIALS NOT FURNISHED BY VIVA RAILINGS. VIVA RAILINGS HAS NO WAY OF KNOWING AND SPECIFICALLY DISCLAIMS WHETHER OR NOT THE BUILDING SYSTEMS TO WHICH VIVA RAILINGS' PRODUCTS ARE TO BE ATTACHED ARE STRUCTURALLY SOUND OR DESIGNED TO PROPERLY SUPPORT VIVA RAILINGS'S MATERIALS. ANY SUCH DESIGN RESPONSIBILITY BELONGS TO OTHERS FOR WHOM VIVA RAILINGS IS NOT RESPONSIBLE. THESE DRAWINGS ARE INTENDED FOR THE SOLE USE OF VIVA RAILINGS' CUSTOMER AND THEIR AGENTS FOR THE INSTALLATION OF PRODUCTS FURNISHED BY VIVA RAILINGS. VIVA RAILINGS REMAINS THE SOLE OWNER OF ALL DESIGNS AND INTELLECTUAL PROPERTY CONTAINED WITHIN. REPRODUCTION AND USE OF THESE DESIGNS FOR ANY OTHER PURPOSE IS FORBIDDEN. SCALES ARE PROVIDED FOR REFERENCE ONLY. FOR PRODUCT INFORMATION AND TECHNICAL SUPPORT, PLEASE CONTACT VIVA RAILINGS.



ALUM. WINDWALL GLASS SCREEN SYSTEM

8 FT. TALL GLASS

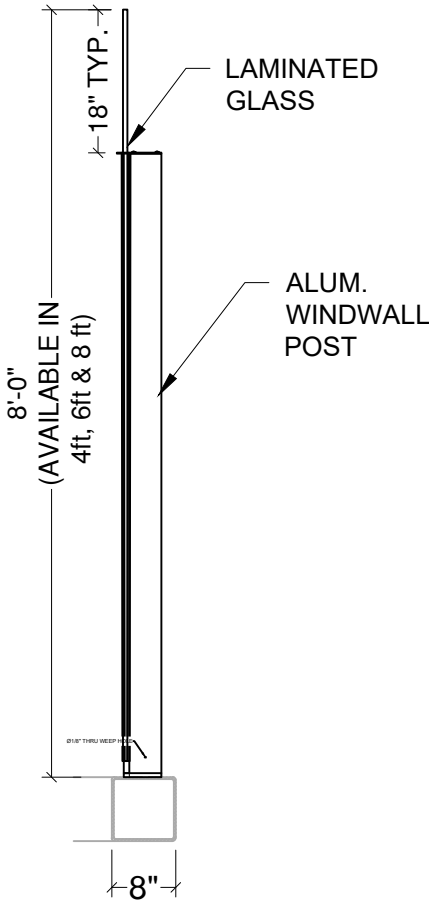
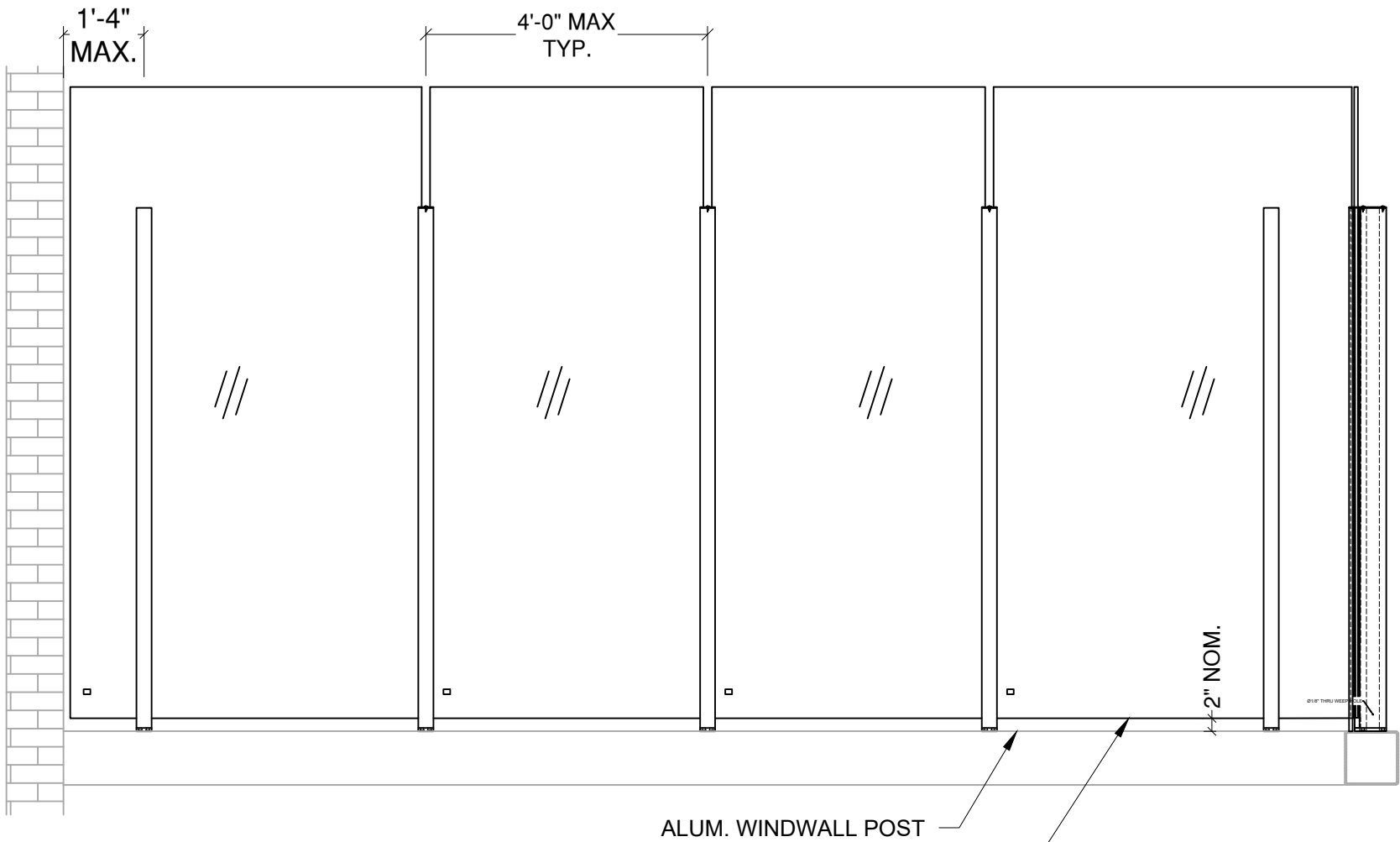
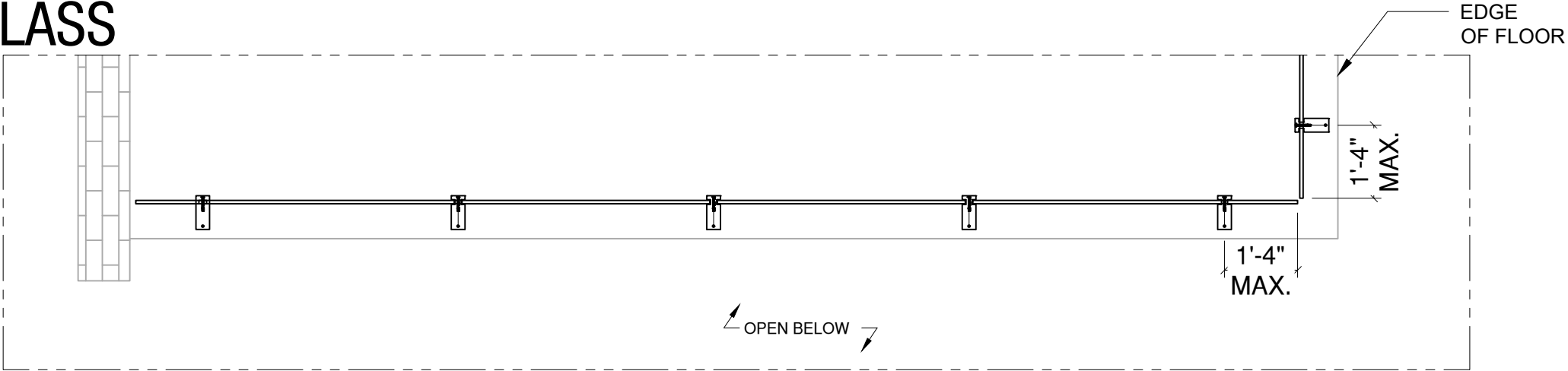

AVAILABLE IN GLASS THICKNESSES OF 1/2", 5/8" & 3/4" WITH CORRESPONDING POST HEIGHTS OPTIONS FOR VISIBILITY PREFERENCE. AS GLASS THICKNESS INCREASES, POST HEIGHT REDUCES AND COST INCREASES .

VIVA RAILINGS IS NOT RESPONSIBLE FOR THE STRUCTURAL INTEGRITY OF ANY BUILDING SYSTEMS OR OTHER MATERIALS NOT FURNISHED BY VIVA RAILINGS. VIVA RAILINGS HAS NO WAY OF KNOWING AND SPECIFICALLY DISCLAIMS WHETHER OR NOT THE BUILDING SYSTEMS TO WHICH VIVA RAILINGS' PRODUCTS ARE TO BE ATTACHED ARE STRUCTURALLY SOUND OR DESIGNED TO PROPERLY SUPPORT VIVA RAILINGS'S MATERIALS. ANY SUCH DESIGN RESPONSIBILITY BELONGS TO OTHERS FOR WHOM VIVA RAILINGS IS NOT RESPONSIBLE. THESE DRAWINGS ARE INTENDED FOR THE SOLE USE OF VIVA RAILINGS' CUSTOMER AND THEIR AGENTS FOR THE INSTALLATION OF PRODUCTS FURNISHED BY VIVA RAILINGS. VIVA RAILINGS REMAINS THE SOLE OWNER OF ALL DESIGNS AND INTELLECTUAL PROPERTY CONTAINED WITHIN. REPRODUCTION AND USE OF THESE DESIGNS FOR ANY OTHER PURPOSE IS FORBIDDEN. SCALES ARE PROVIDED FOR REFERENCE ONLY. FOR PRODUCT INFORMATION AND TECHNICAL SUPPORT, PLEASE CONTACT VIVA RAILINGS.



ALUM. WINDWALL GLASS SCREEN SYSTEM

MOUNTING CONDITION, GLASS ON TRAFFIC SIDE

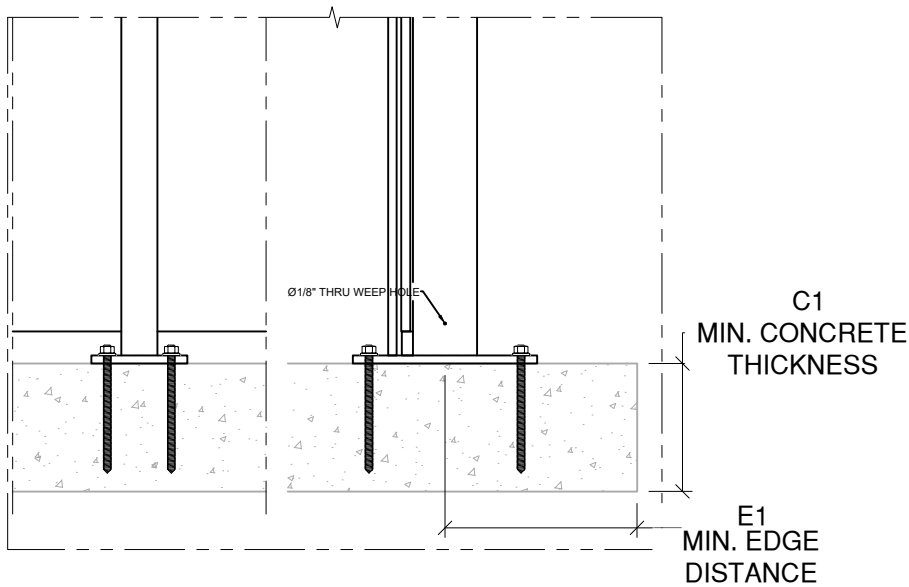

Anchored to Concrete ¹ - \$\$ ²

Detail# AW-T01

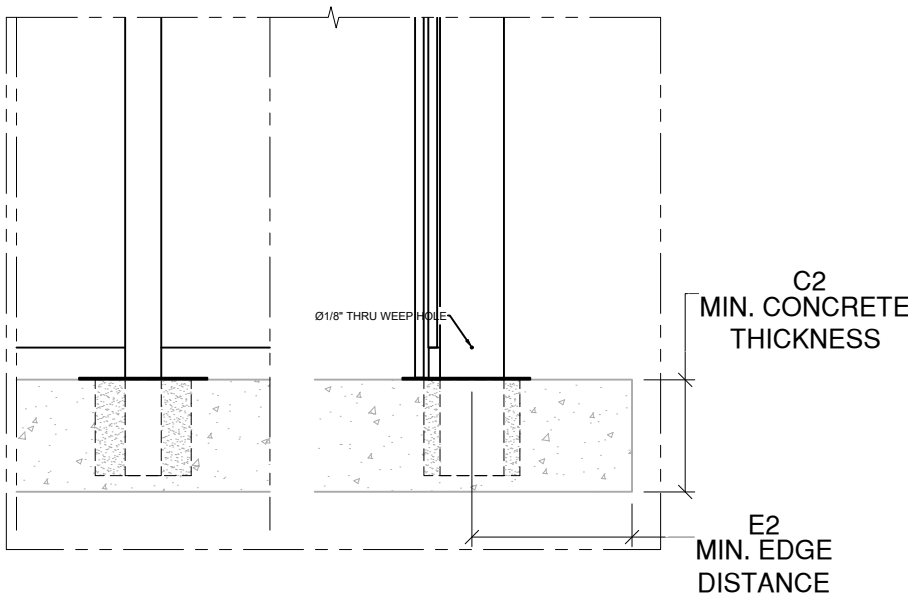

Cored into Concrete - \$\$

Detail# AW-T02

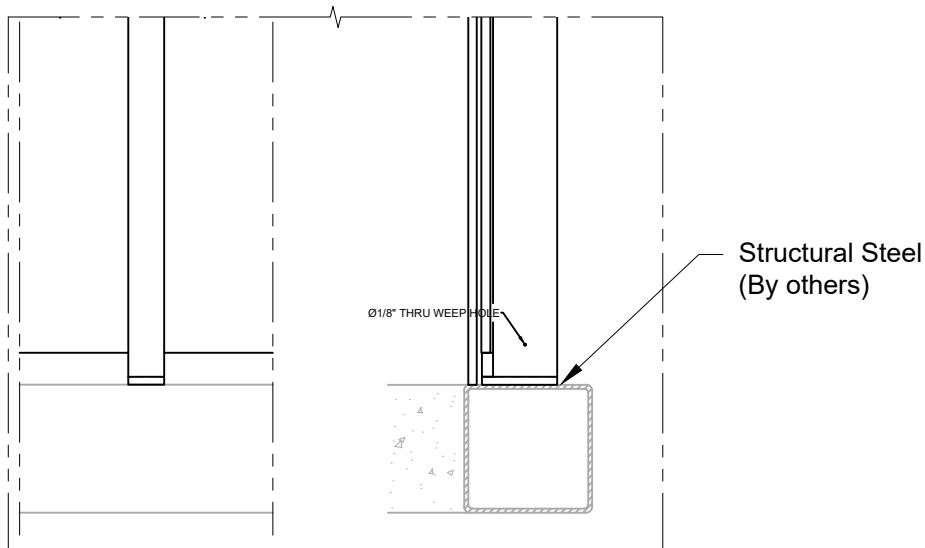

Welded @ Steel - \$

Detail# AW-T03

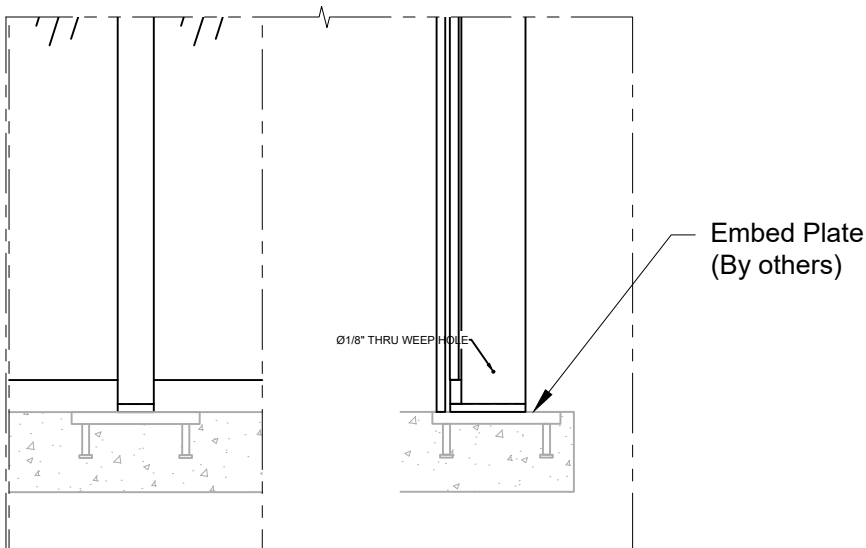

Welded @ Embed Plate - \$

Detail# AW-T04

Min. REQUIRED DIMENSIONS					
REFERENCE CODE	H WINDWALL HEIGHT	ANCHOR MOUNT		CORE MOUNT	
		C1 CONCRETE THICKNESS	E1 EDGE DISTANCE	C2 CONCRETE THICKNESS	E2 EDGE DISTANCE
VWP-542248	4'-0"	5	8	7	10
VWP-542260	5'-0"	8	10	8	11
VWP-542272	6'-0"	10	12	8	11
VWP-542296	8'-0"	12	14	9	11

(1) Min. 4000 PSI concrete, Typ.
(2) \$ to \$\$\$: Indicates mounting type comparative cost
(3) Glass can be oriented facing traffic or non-traffic side, details above show non-traffic side



ALUM. WINDWALL GLASS SCREEN SYSTEM

CURVED LAYOUT

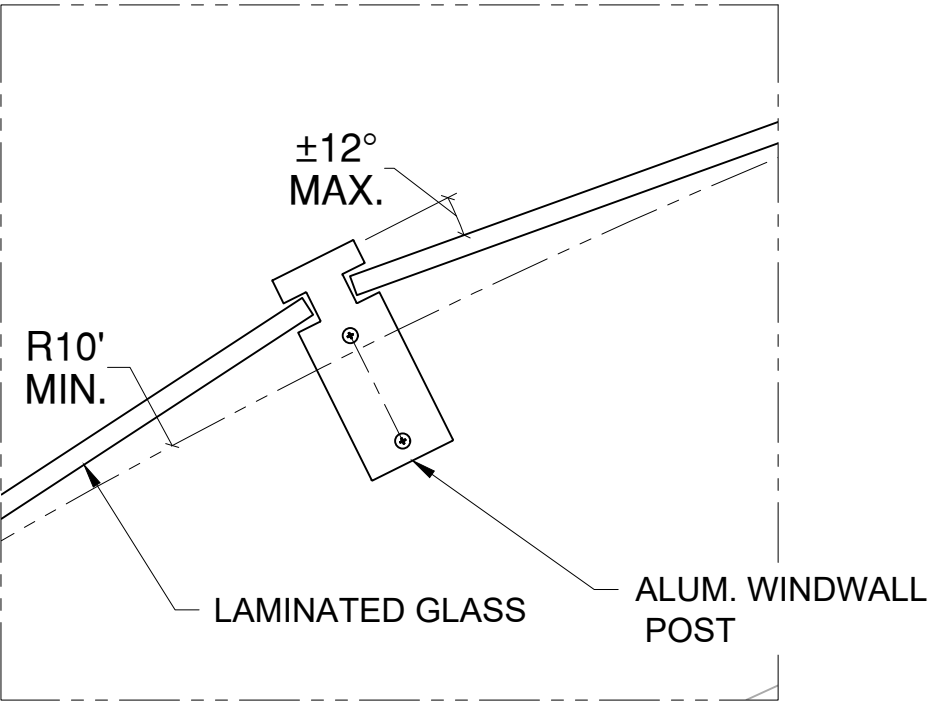
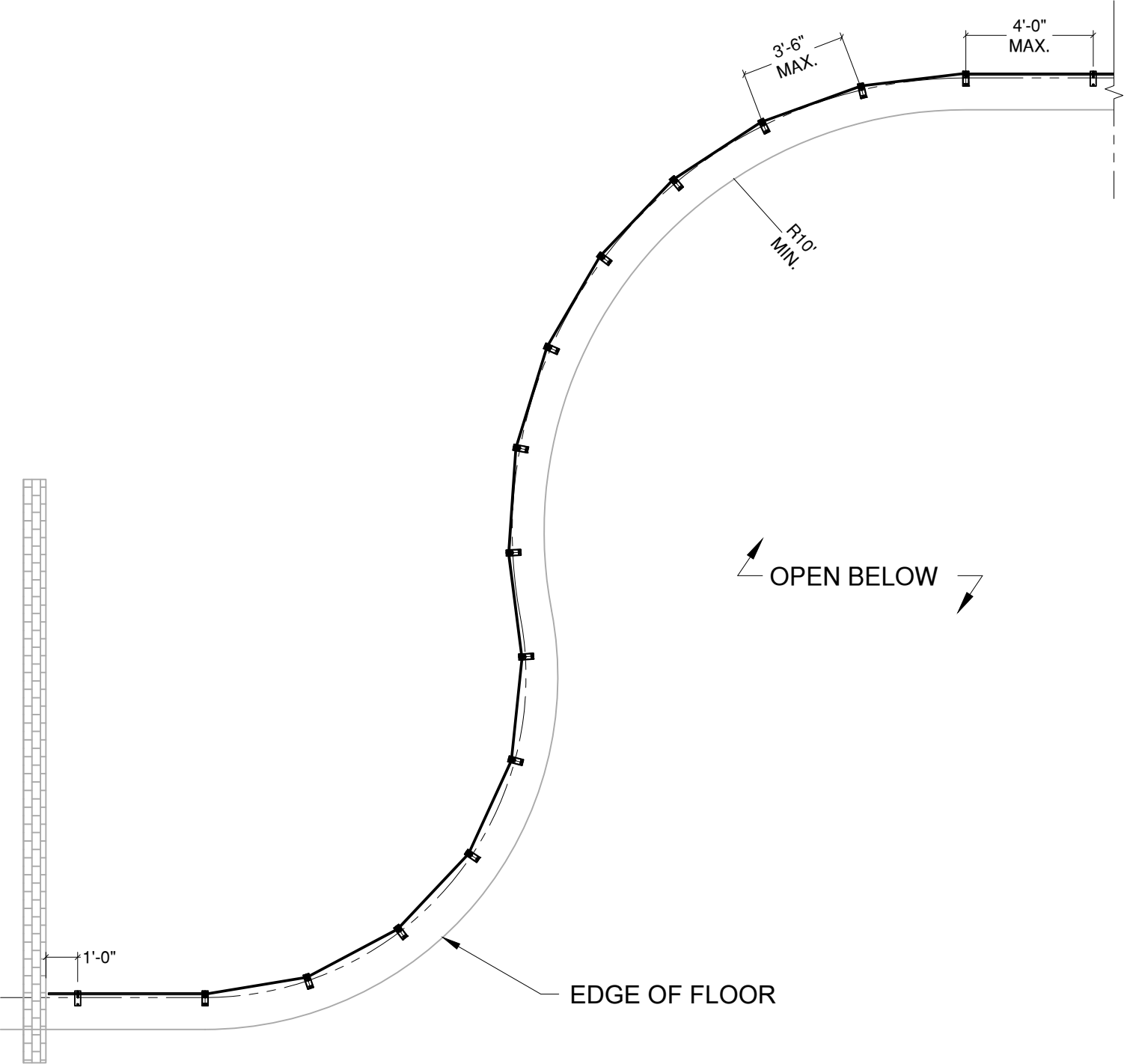

VIVA RAILINGS IS NOT RESPONSIBLE FOR THE STRUCTURAL INTEGRITY OF ANY BUILDING SYSTEMS OR OTHER MATERIALS NOT FURNISHED BY VIVA RAILINGS. VIVA RAILINGS HAS NO WAY OF KNOWING AND SPECIFICALLY DISCLAIMS WHETHER OR NOT THE BUILDING SYSTEMS TO WHICH VIVA RAILINGS' PRODUCTS ARE TO BE ATTACHED ARE STRUCTURALLY SOUND OR DESIGNED TO PROPERLY SUPPORT VIVA RAILINGS'S MATERIALS. ANY SUCH DESIGN RESPONSIBILITY BELONGS TO OTHERS FOR WHOM VIVA RAILINGS IS NOT RESPONSIBLE. THESE DRAWINGS ARE INTENDED FOR THE SOLE USE OF VIVA RAILINGS' CUSTOMER AND THEIR AGENTS FOR THE INSTALLATION OF PRODUCTS FURNISHED BY VIVA RAILINGS. VIVA RAILINGS REMAINS THE SOLE OWNER OF ALL DESIGNS AND INTELLECTUAL PROPERTY CONTAINED WITHIN. REPRODUCTION AND USE OF THESE DESIGNS FOR ANY OTHER PURPOSE IS FORBIDDEN. SCALES ARE PROVIDED FOR REFERENCE ONLY. FOR PRODUCT INFORMATION AND TECHNICAL SUPPORT, PLEASE CONTACT VIVA RAILINGS.



ALUM. WINDWALL GLASS SCREEN SYSTEM

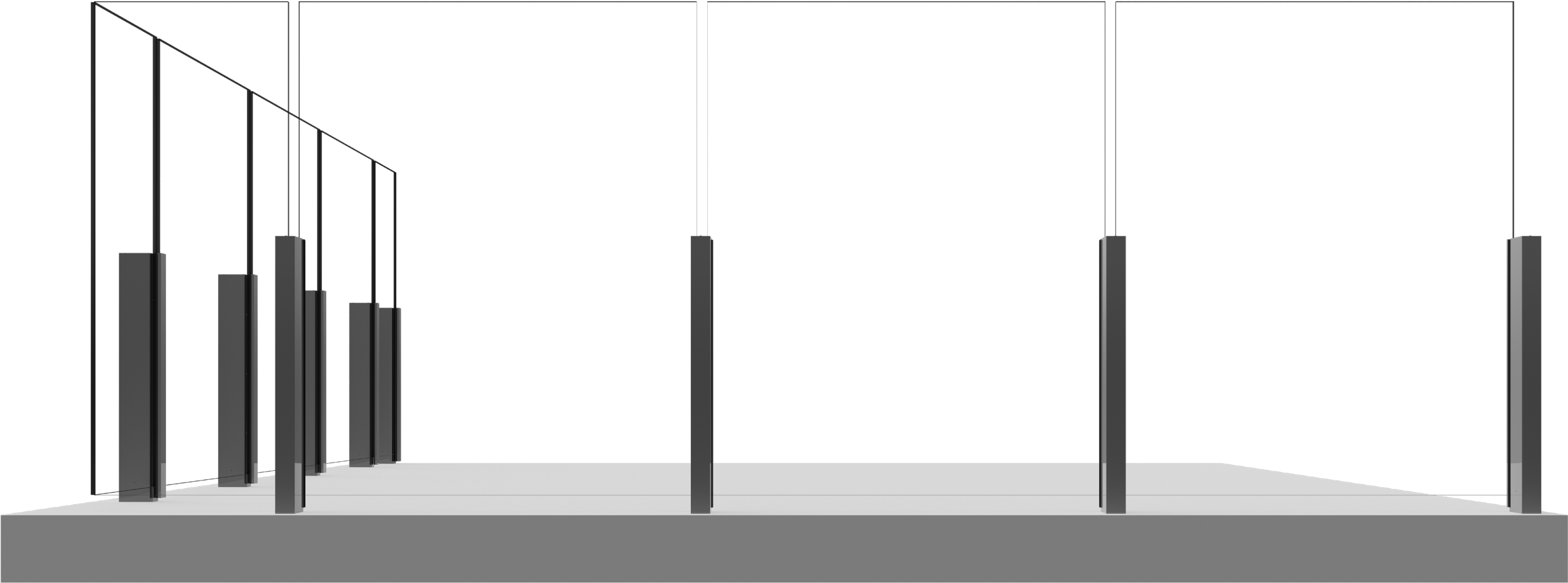

ALUM. WINDWALL GLASS SCREEN SYSTEM

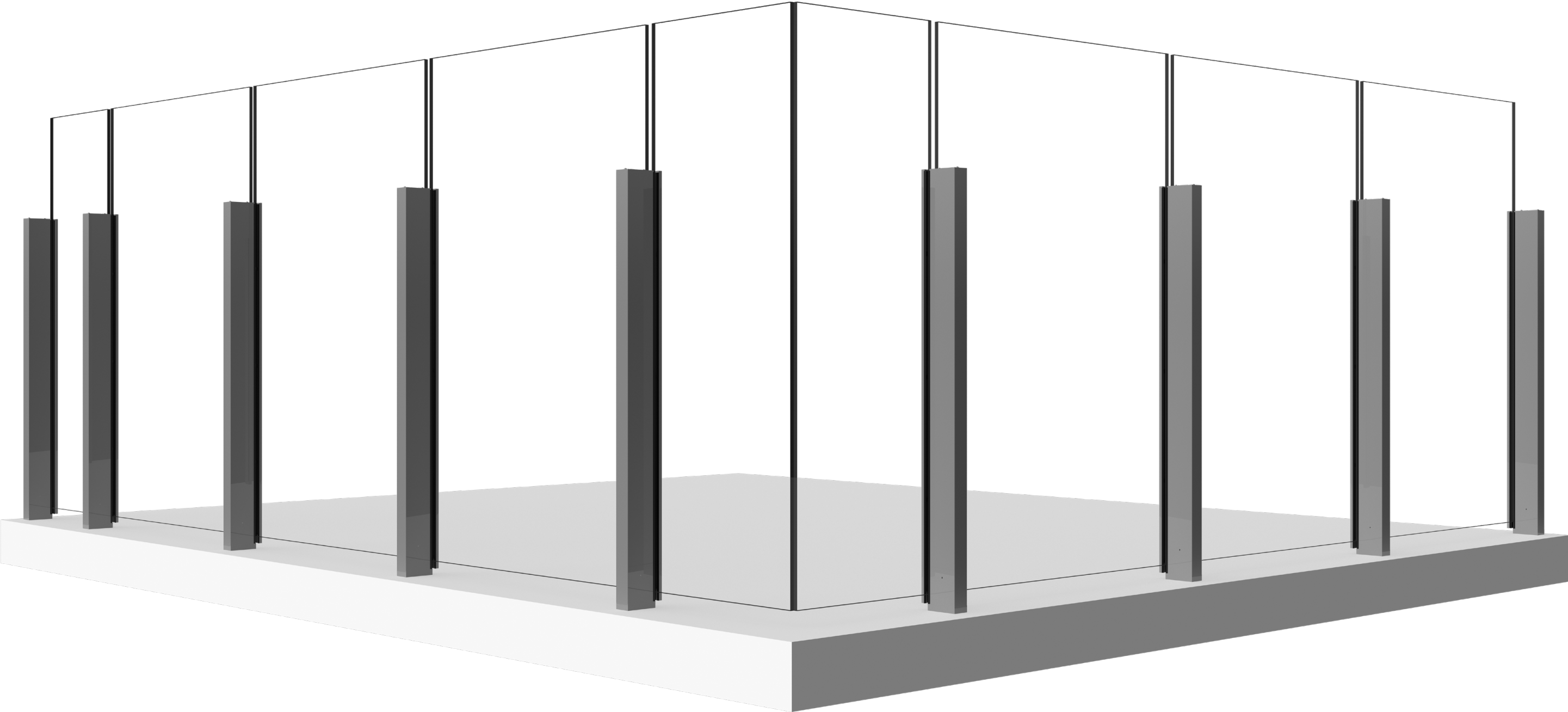

ALUM. WINDWALL GLASS SCREEN SYSTEM

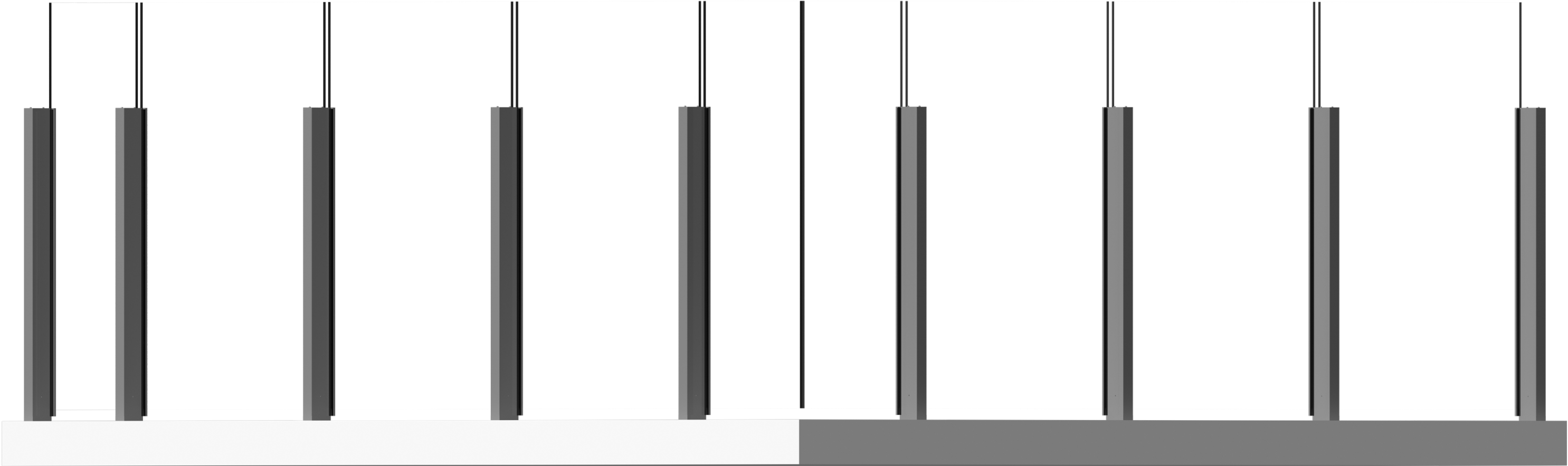



DESIGN + ENGINEER + FABRICATE + INSTALL

151 W. Vista Ridge Mall Dr. Lewisville, TX 75067

(Dallas/Fort Worth Metroplex)

PH: 972.353.8482 | info@vivarailings.com
vivarailings.com



Inc. Magazine 500 | 5000
VIVA RAILINGS, LLC.
Among The Fastest Growing
US Companies
Eight Years in a Row
2012-2019

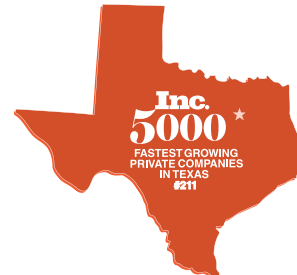

Inc. Magazine 500 | 5000
VIVA RAILINGS, LLC.
Among The Fastest Growing
Texas Companies
#211



ICC-ES 4405 Certified
SHOE™
Structural Glass Railing System



LEED
Material & Resources Credits 4.1 and 4.2



The American Institute of Architects



The California Contractors State License
Board Certified