

ALUM. WINDWALL AVAILABLE INFILLS

Glass

# ALUM. WINDWALL™ GLASS SCREEN SYSTEM PRODUCT DATA



DESIGN + ENGINEER + FABRICATE + INSTALL

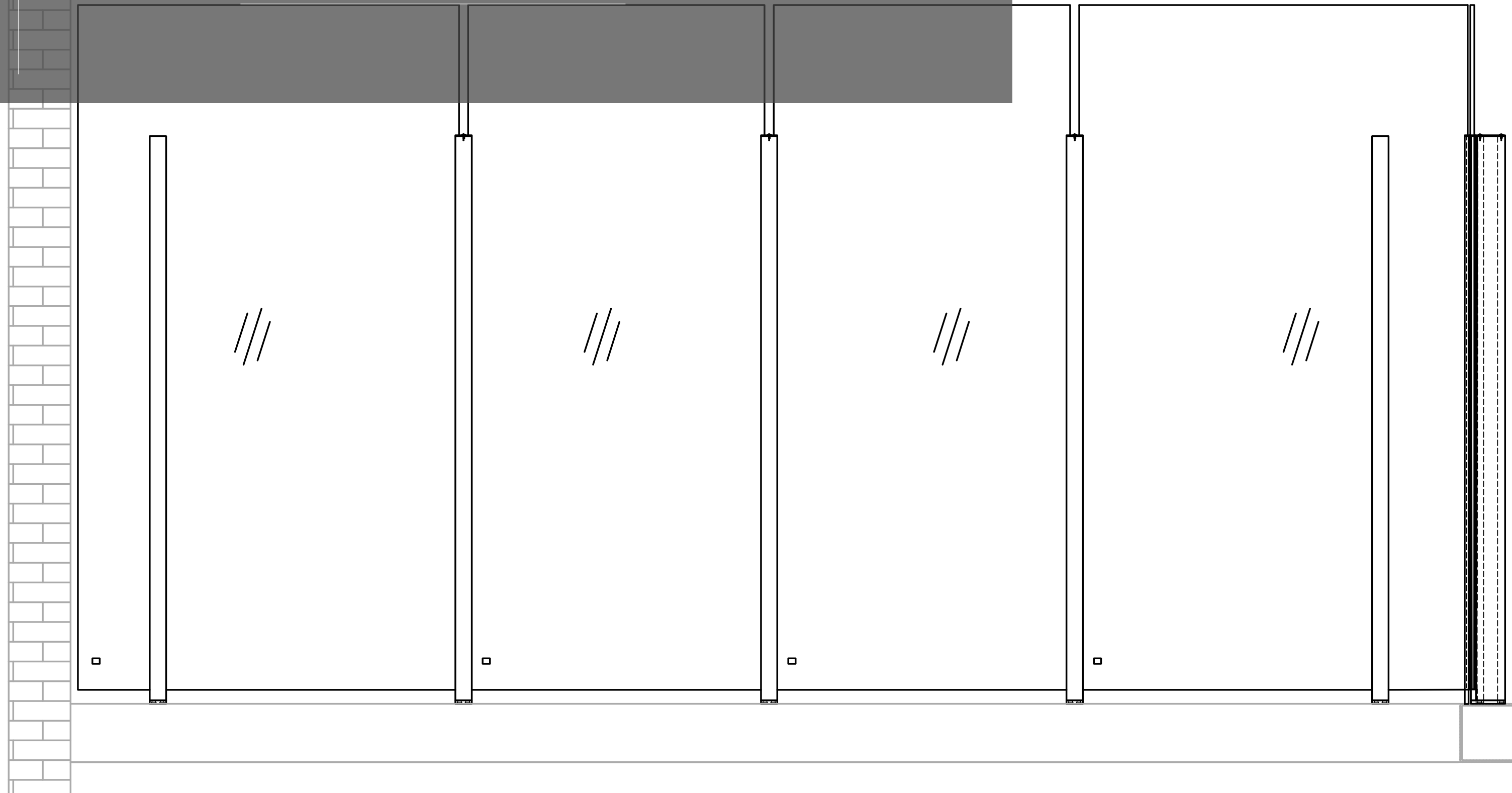

# ALUM. WINDWALL™ GLASS SCREEN SYSTEM

ALUM. WINDWALL AVAILABLE INFILLS

Glass

The ALUM. WINDWALL system is an alternative addition to our SS WINDWALL system and is typically used at amenity deck levels in high-rise residential projects or by poolside.

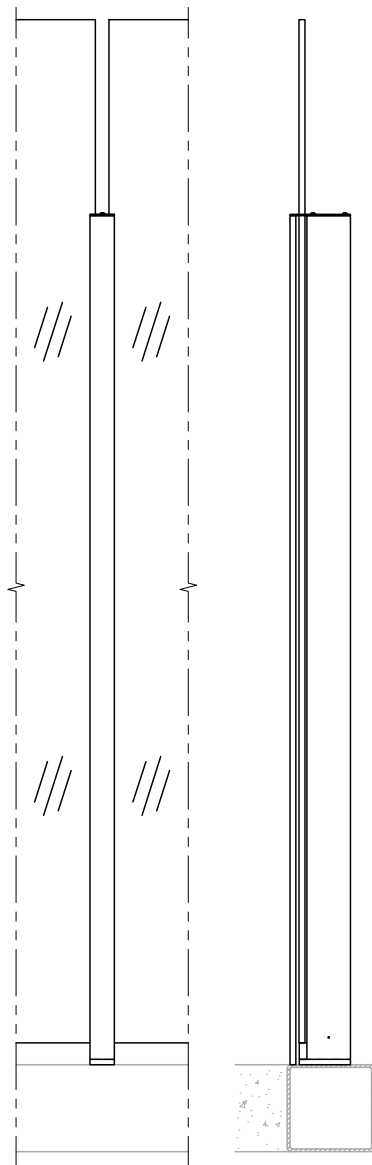

Other mounting options available.

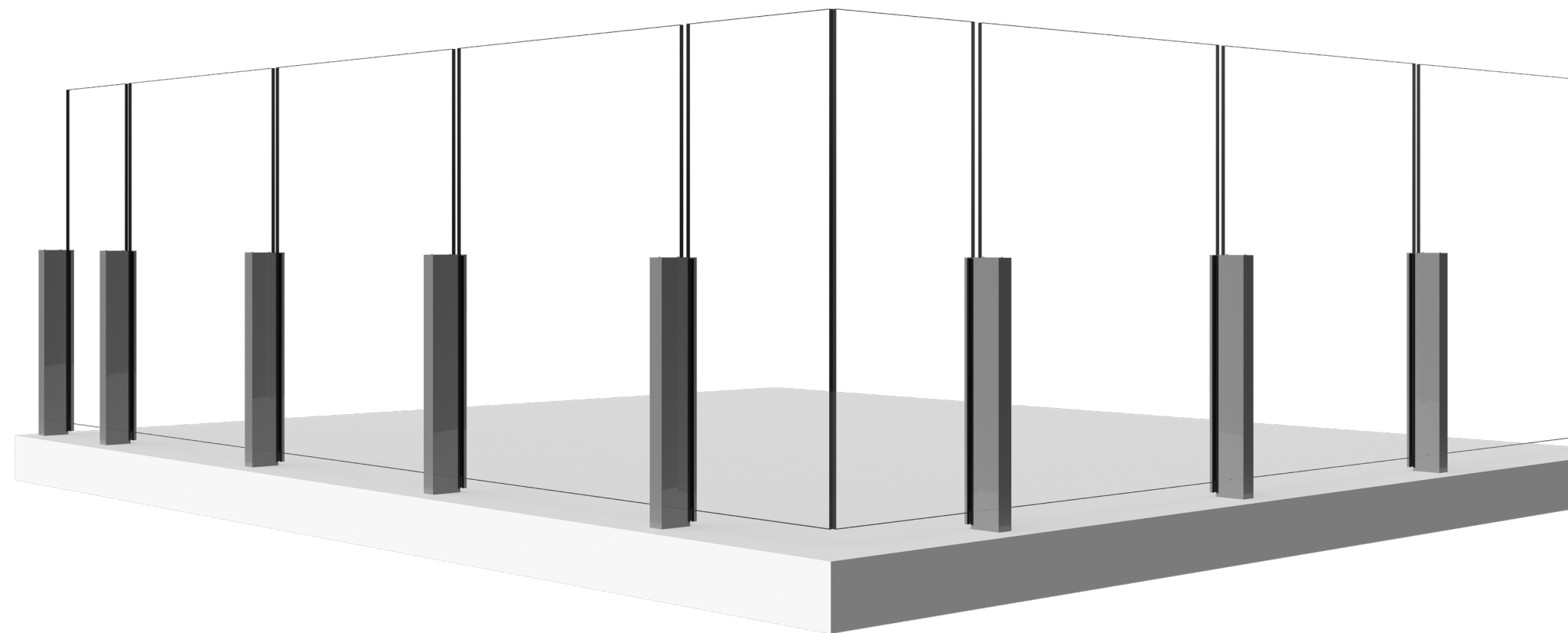

# ALUM. WINDWALL™ GLASS SCREEN SYSTEM - TECHNICAL DATA

	MATERIAL	FINISH	SIZE/SPACING
<b>POST</b>	ALUM.	Powder Coat Super Polyester (AAMA 2604) <sup>2</sup> Powder Coat PVDF (AAMA 2605)	2 1/4"x5 7/16" Square post @ 4'-0" max. O.C. 4'-0", 6'-0" & 8'-0" Height Alum. Windwall. Anchored, Cored or Welded mount.
<b>INFILL</b>	Glass	Clear, Tinted or Frit	Min. 1/2" laminated glass with SGP interlayer <sup>1</sup> Glass standard thickness: 1/2", 5/8", 3/4" Interlayer standard thickness, SGP: 0.035", 0.06"

## FINISHING OPTIONS

**POWDER COAT**

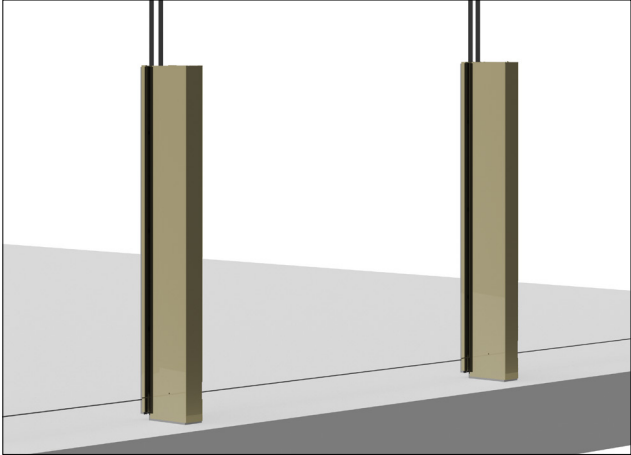

1. IBC 2015 & newer requires railing glass to be laminated. VIVA rALUM.mmends SGP for exterior applications.

2. \$ to \$\$\$: indicates finish type comparative cost.



# ALUM. WINDWALL GLASS SCREEN SYSTEM

## 4 FT. TALL GLASS

### AVAILABLE GLASS TYPES



Clear Laminated (SGP)

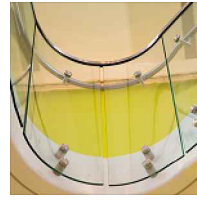

Bent

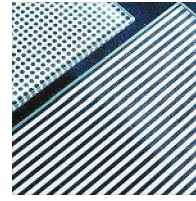

Ceramic Frit



Tinted



Satin Etched

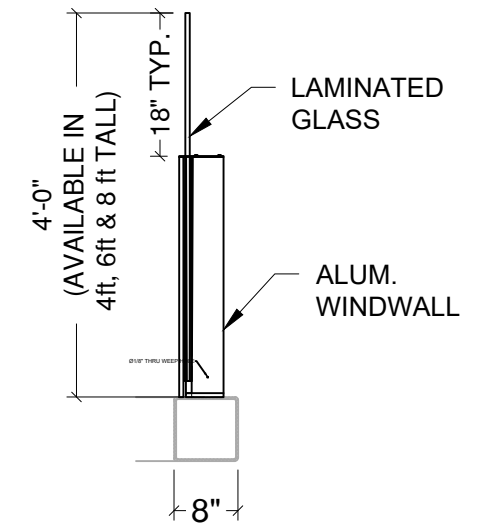
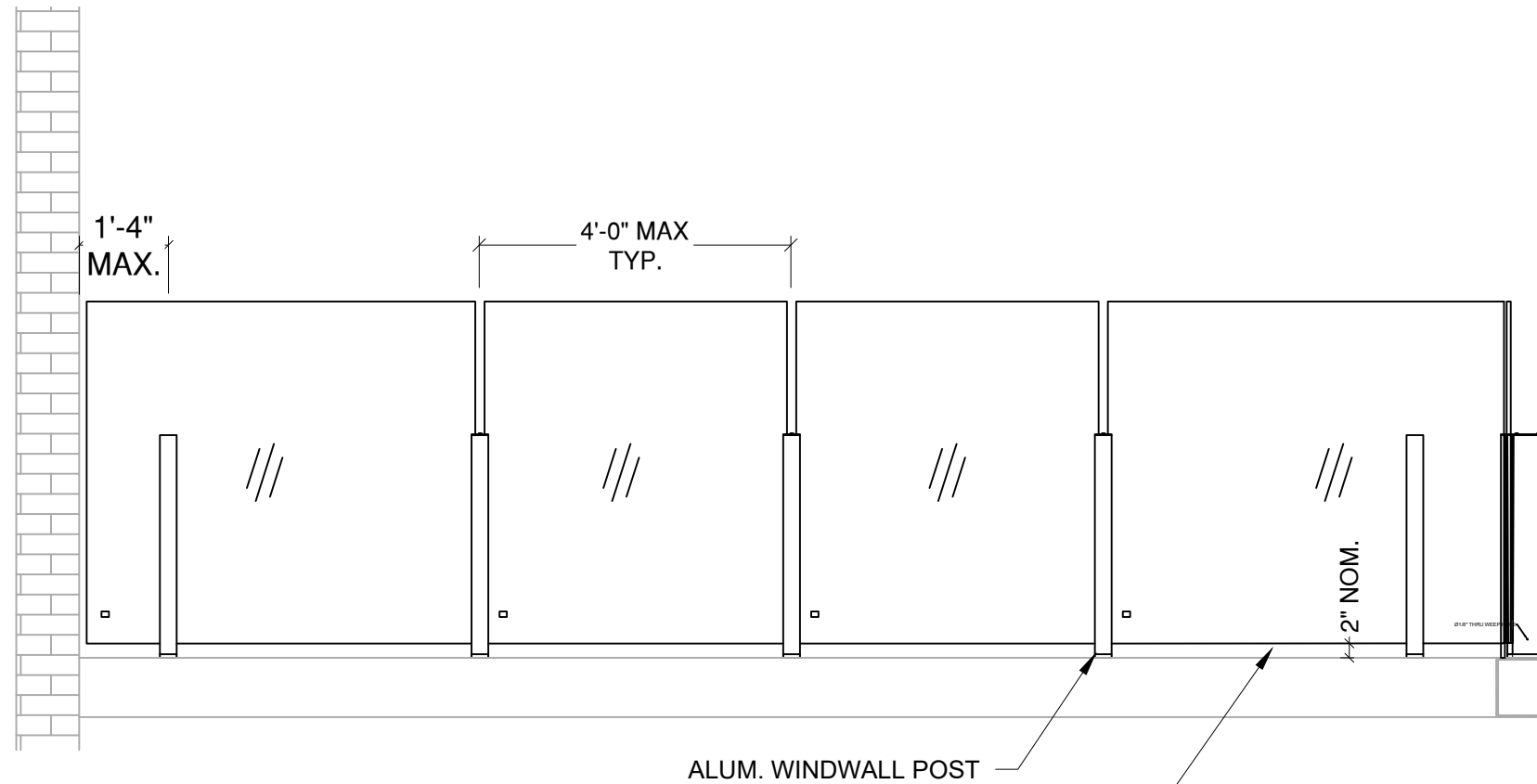
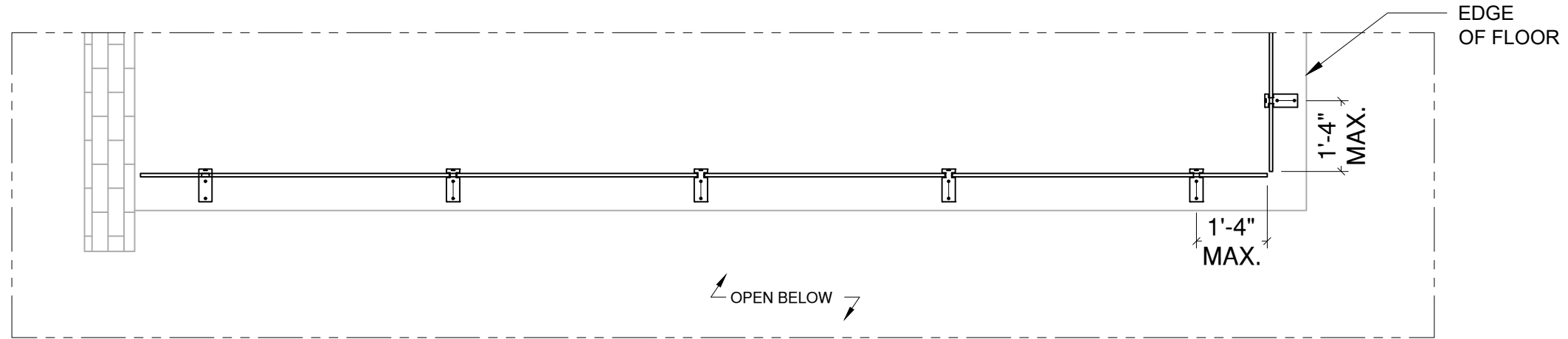

AVAILABLE IN GLASS THICKNESSES OF 1/2", 5/8" & 3/4" WITH CORRESPONDING POST HEIGHTS OPTIONS FOR VISIBILITY PREFERENCE. AS GLASS THICKNESS INCREASES, POST HEIGHT REDUCES AND COST INCREASES .

LAMINATED GLASS

VIVA RAILINGS IS NOT RESPONSIBLE FOR THE STRUCTURAL INTEGRITY OF ANY BUILDING SYSTEMS OR OTHER MATERIALS NOT FURNISHED BY VIVA RAILINGS. VIVA RAILINGS HAS NO WAY OF KNOWING AND SPECIFICALLY DISCLAIMS WHETHER OR NOT THE BUILDING SYSTEMS TO WHICH VIVA RAILINGS' PRODUCTS ARE TO BE ATTACHED ARE STRUCTURALLY SOUND OR DESIGNED TO PROPERLY SUPPORT VIVA RAILINGS'S MATERIALS. ANY SUCH DESIGN RESPONSIBILITY BELONGS TO OTHERS FOR WHOM VIVA RAILINGS IS NOT RESPONSIBLE. THESE DRAWINGS ARE INTENDED FOR THE SOLE USE OF VIVA RAILINGS' CUSTOMER AND THEIR AGENTS FOR THE INSTALLATION OF PRODUCTS FURNISHED BY VIVA RAILINGS. VIVA RAILINGS REMAINS THE SOLE OWNER OF ALL DESIGNS AND INTELLECTUAL PROPERTY CONTAINED WITHIN. REPRODUCTION AND USE OF THESE DESIGNS FOR ANY OTHER PURPOSE IS FORBIDDEN. SCALES ARE PROVIDED FOR REFERENCE ONLY. FOR PRODUCT INFORMATION AND TECHNICAL SUPPORT, PLEASE CONTACT VIVA RAILINGS.



# ALUM. WINDWALL GLASS SCREEN SYSTEM

## 6 FT. TALL GLASS

### AVAILABLE GLASS TYPES



Clear Laminated (SGP)

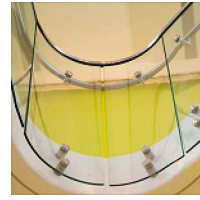

Bent

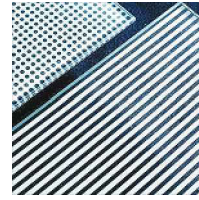

Ceramic Frit



Tinted



Satin Etched

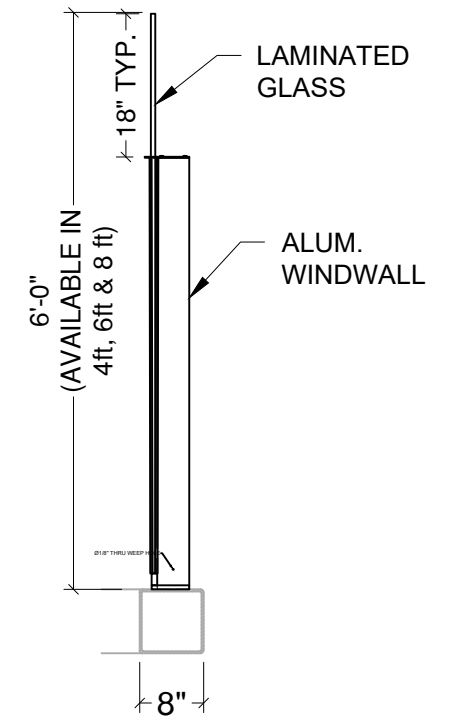
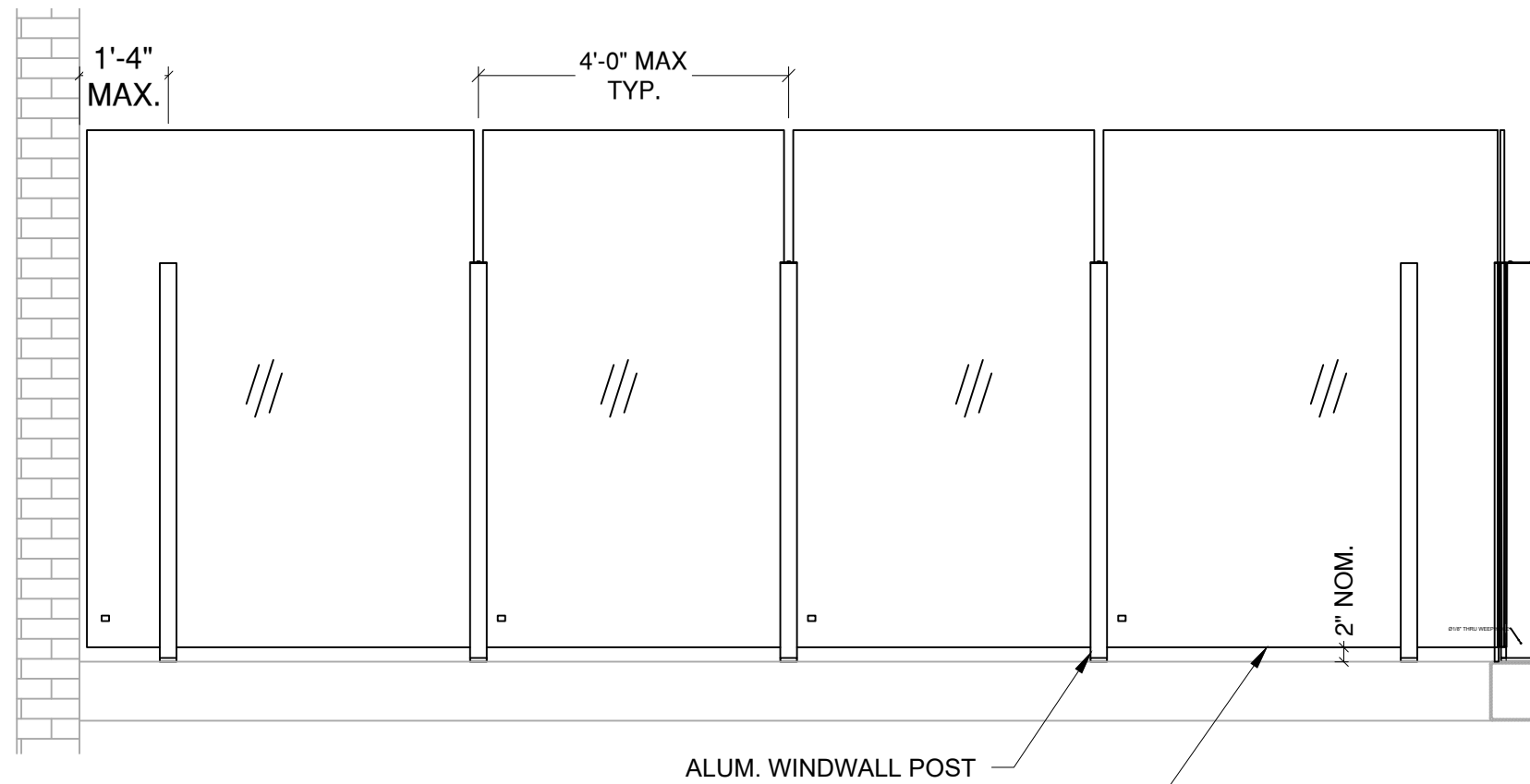
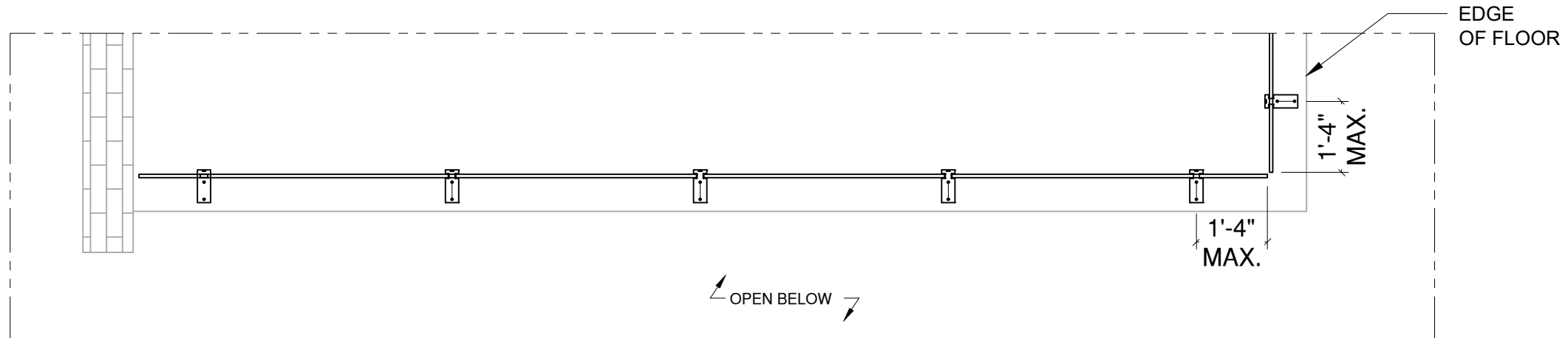

AVAILABLE IN GLASS THICKNESSES OF 1/2", 5/8" & 3/4" WITH CORRESPONDING POST HEIGHTS OPTIONS FOR VISIBILITY PREFERENCE. AS GLASS THICKNESS INCREASES, POST HEIGHT REDUCES AND COST INCREASES .

LAMINATED GLASS

VIVA RAILINGS IS NOT RESPONSIBLE FOR THE STRUCTURAL INTEGRITY OF ANY BUILDING SYSTEMS OR OTHER MATERIALS NOT FURNISHED BY VIVA RAILINGS. VIVA RAILINGS HAS NO WAY OF KNOWING AND SPECIFICALLY DISCLAIMS WHETHER OR NOT THE BUILDING SYSTEMS TO WHICH VIVA RAILINGS' PRODUCTS ARE TO BE ATTACHED ARE STRUCTURALLY SOUND OR DESIGNED TO PROPERLY SUPPORT VIVA RAILINGS'S MATERIALS. ANY SUCH DESIGN RESPONSIBILITY BELONGS TO OTHERS FOR WHOM VIVA RAILINGS IS NOT RESPONSIBLE. THESE DRAWINGS ARE INTENDED FOR THE SOLE USE OF VIVA RAILINGS' CUSTOMER AND THEIR AGENTS FOR THE INSTALLATION OF PRODUCTS FURNISHED BY VIVA RAILINGS. VIVA RAILINGS REMAINS THE SOLE OWNER OF ALL DESIGNS AND INTELLECTUAL PROPERTY CONTAINED WITHIN. REPRODUCTION AND USE OF THESE DESIGNS FOR ANY OTHER PURPOSE IS FORBIDDEN. SCALES ARE PROVIDED FOR REFERENCE ONLY. FOR PRODUCT INFORMATION AND TECHNICAL SUPPORT, PLEASE CONTACT VIVA RAILINGS.



# ALUM. WINDWALL GLASS SCREEN SYSTEM

## 8 FT. TALL GLASS

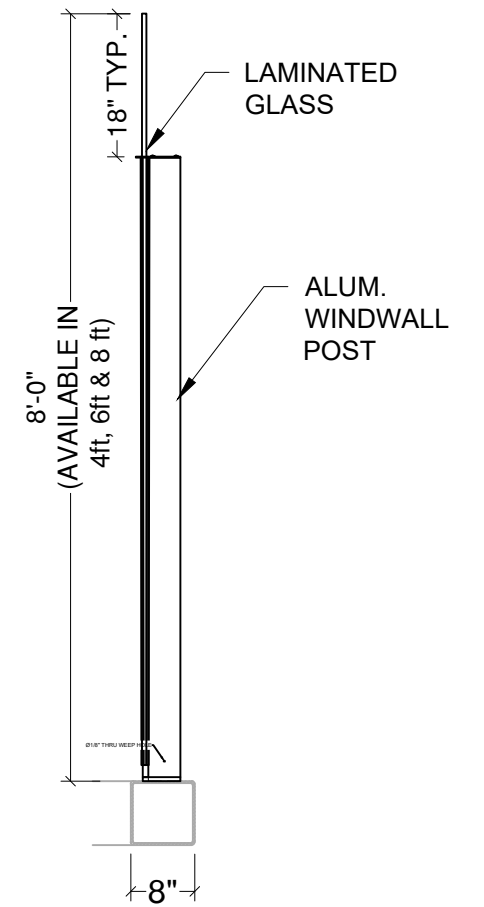
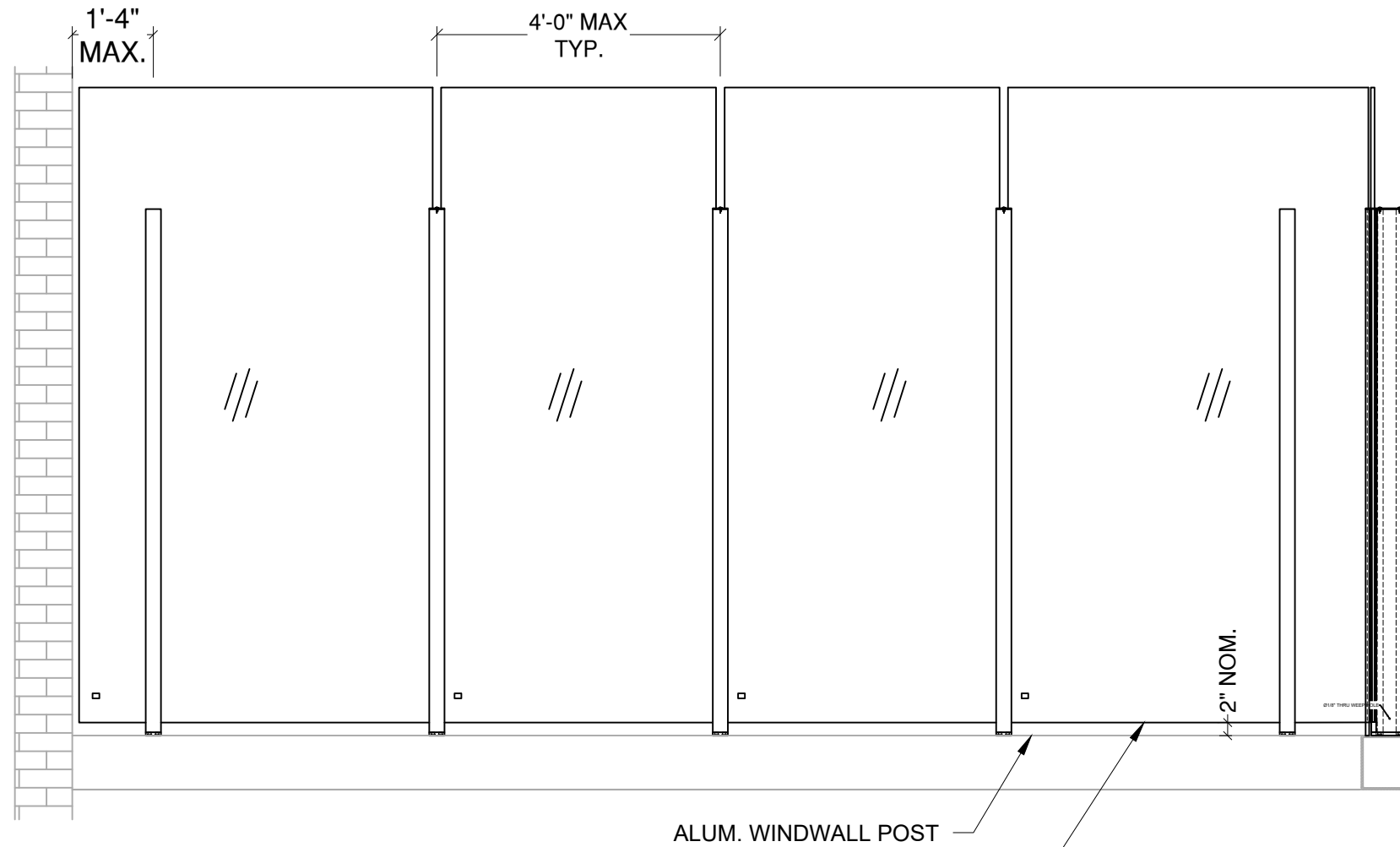
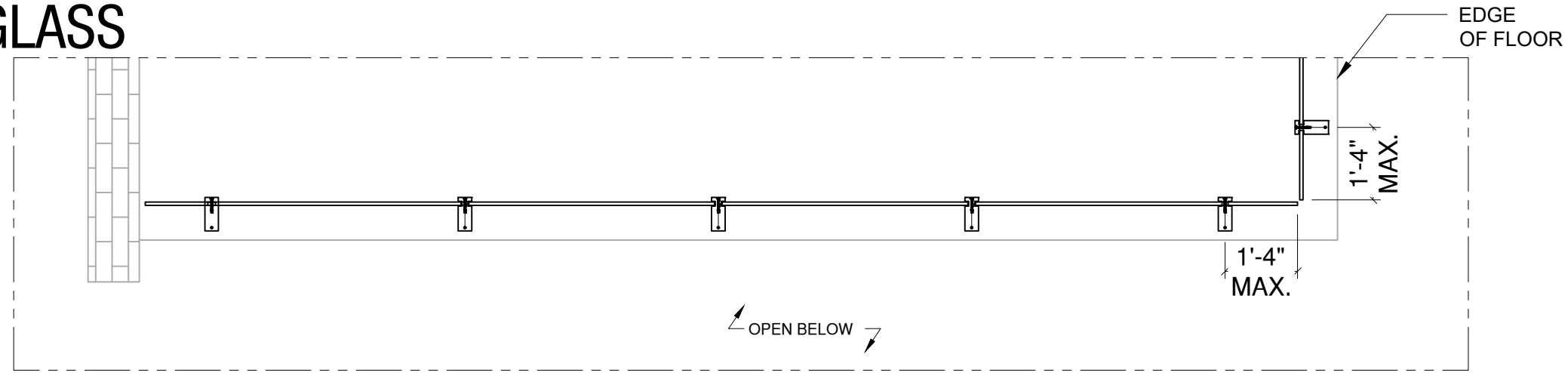

AVAILABLE IN GLASS THICKNESSES OF 1/2", 5/8" & 3/4" WITH CORRESPONDING POST HEIGHTS OPTIONS FOR VISIBILITY PREFERENCE. AS GLASS THICKNESS INCREASES, POST HEIGHT REDUCES AND COST INCREASES.

LAMINATED GLASS

VIVA RAILINGS IS NOT RESPONSIBLE FOR THE STRUCTURAL INTEGRITY OF ANY BUILDING SYSTEMS OR OTHER MATERIALS NOT FURNISHED BY VIVA RAILINGS. VIVA RAILINGS HAS NO WAY OF KNOWING AND SPECIFICALLY DISCLAIMS WHETHER OR NOT THE BUILDING SYSTEMS TO WHICH VIVA RAILINGS' PRODUCTS ARE TO BE ATTACHED ARE STRUCTURALLY SOUND OR DESIGNED TO PROPERLY SUPPORT VIVA RAILINGS'S MATERIALS. ANY SUCH DESIGN RESPONSIBILITY BELONGS TO OTHERS FOR WHOM VIVA RAILINGS IS NOT RESPONSIBLE. THESE DRAWINGS ARE INTENDED FOR THE SOLE USE OF VIVA RAILINGS' CUSTOMER AND THEIR AGENTS FOR THE INSTALLATION OF PRODUCTS FURNISHED BY VIVA RAILINGS. VIVA RAILINGS REMAINS THE SOLE OWNER OF ALL DESIGNS AND INTELLECTUAL PROPERTY CONTAINED WITHIN. REPRODUCTION AND USE OF THESE DESIGNS FOR ANY OTHER PURPOSE IS FORBIDDEN. SCALES ARE PROVIDED FOR REFERENCE ONLY. FOR PRODUCT INFORMATION AND TECHNICAL SUPPORT, PLEASE CONTACT VIVA RAILINGS.



# ALUM. WINDWALL GLASS SCREEN SYSTEM

## MOUNTING CONDITION, GLASS ON TRAFFIC SIDE

Min. REQUIRED DIMENSIONS					
REFERENCE CODE	H WINDWALL HEIGHT	ANCHOR MOUNT		CORE MOUNT	
		C1 CONCRETE THICKNESS	E1 EDGE DISTANCE	C2 CONCRETE THICKNESS	E2 EDGE DISTANCE
VWP-542248	4'-0"	5	8	7	10
VWP-542260	5'-0"	8	10	8	11
VWP-542272	6'-0"	10	12	8	11
VWP-542296	8'-0"	12	14	9	11

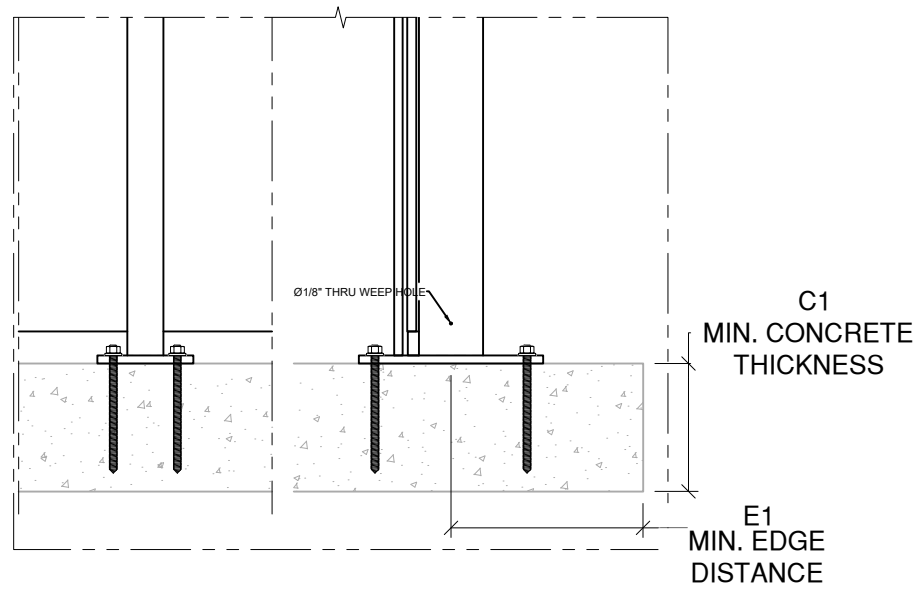

Anchored to Concrete <sup>1</sup> - \$\$\$ <sup>2</sup>

Detail# AW-T01

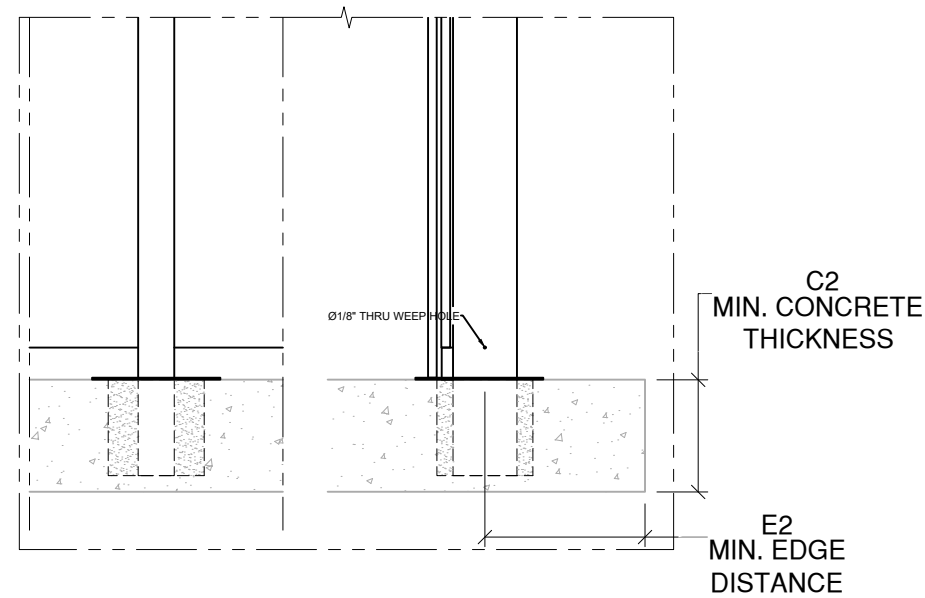

Cored into Concrete - \$\$

Detail# AW-T02

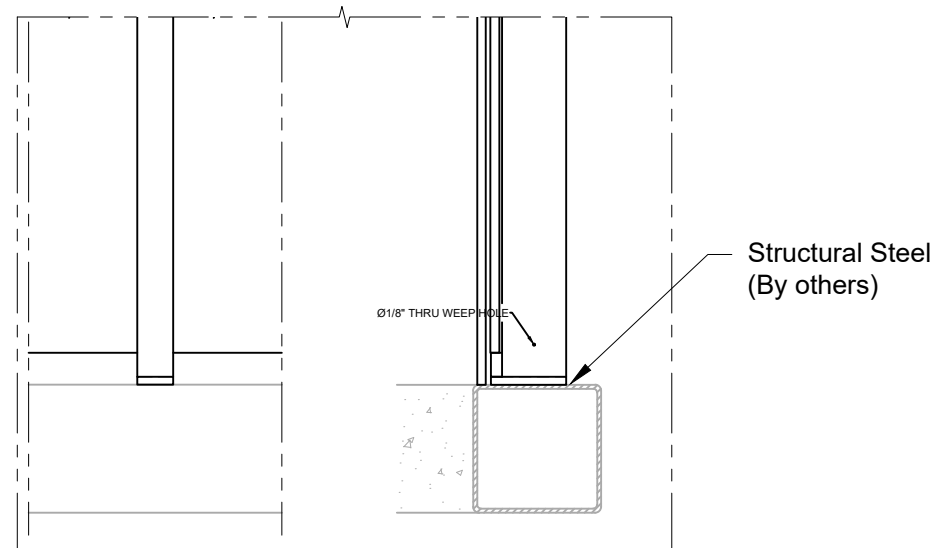

Welded @ Steel - \$

Detail# AW-T03

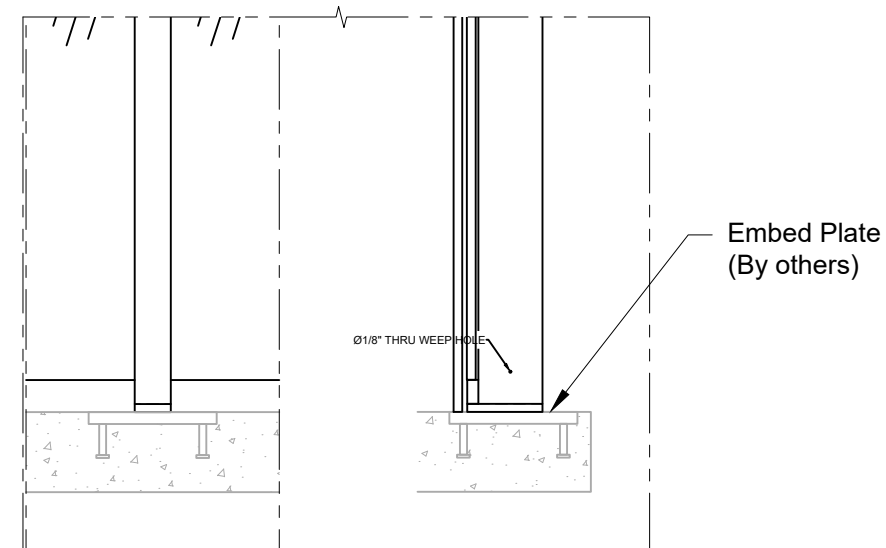

Welded @ Embed Plate - \$

Detail# AW-T04

(1) Min. 4000 PSI concrete, Typ.

(2) \$ to \$\$\$: Indicates mounting type comparative cost

(3) Glass can be oriented facing traffic or non-traffic side, details above show non-traffic side

# ALUM. WINDWALL GLASS SCREEN SYSTEM

## CURVED LAYOUT

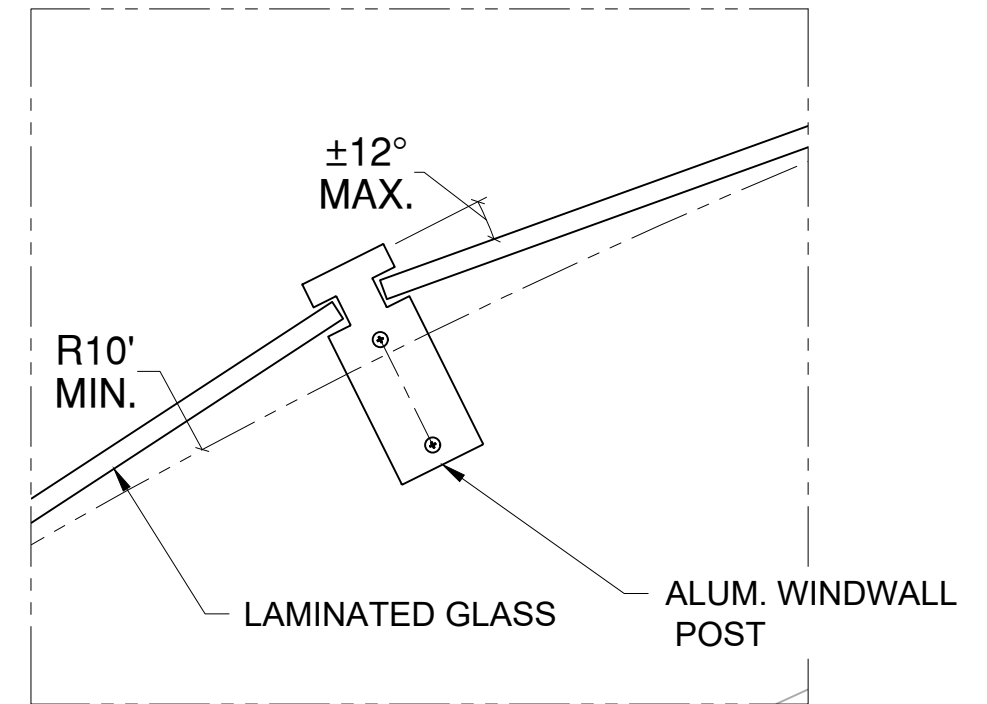
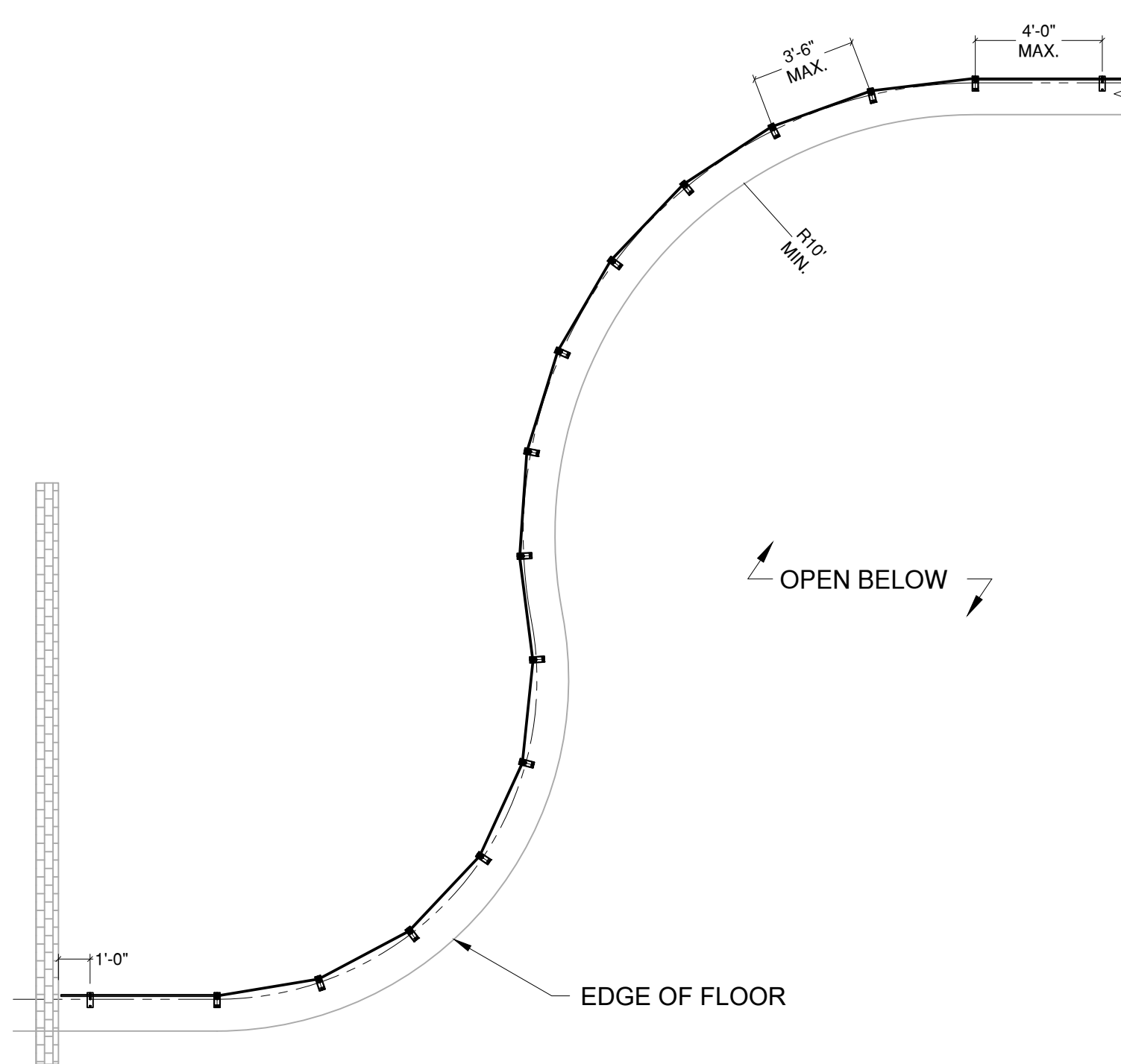

VIVA RAILINGS IS NOT RESPONSIBLE FOR THE STRUCTURAL INTEGRITY OF ANY BUILDING SYSTEMS OR OTHER MATERIALS NOT FURNISHED BY VIVA RAILINGS. VIVA RAILINGS HAS NO WAY OF KNOWING AND SPECIFICALLY DISCLAIMS WHETHER OR NOT THE BUILDING SYSTEMS TO WHICH VIVA RAILINGS' PRODUCTS ARE TO BE ATTACHED ARE STRUCTURALLY SOUND OR DESIGNED TO PROPERLY SUPPORT VIVA RAILINGS'S MATERIALS. ANY SUCH DESIGN RESPONSIBILITY BELONGS TO OTHERS FOR WHOM VIVA RAILINGS IS NOT RESPONSIBLE. THESE DRAWINGS ARE INTENDED FOR THE SOLE USE OF VIVA RAILINGS' CUSTOMER AND THEIR AGENTS FOR THE INSTALLATION OF PRODUCTS FURNISHED BY VIVA RAILINGS. VIVA RAILINGS REMAINS THE SOLE OWNER OF ALL DESIGNS AND INTELLECTUAL PROPERTY CONTAINED WITHIN. REPRODUCTION AND USE OF THESE DESIGNS FOR ANY OTHER PURPOSE IS FORBIDDEN. SCALES ARE PROVIDED FOR REFERENCE ONLY. FOR PRODUCT INFORMATION AND TECHNICAL SUPPORT, PLEASE CONTACT VIVA RAILINGS.





# ALUM. WINDWALL GLASS SCREEN SYSTEM

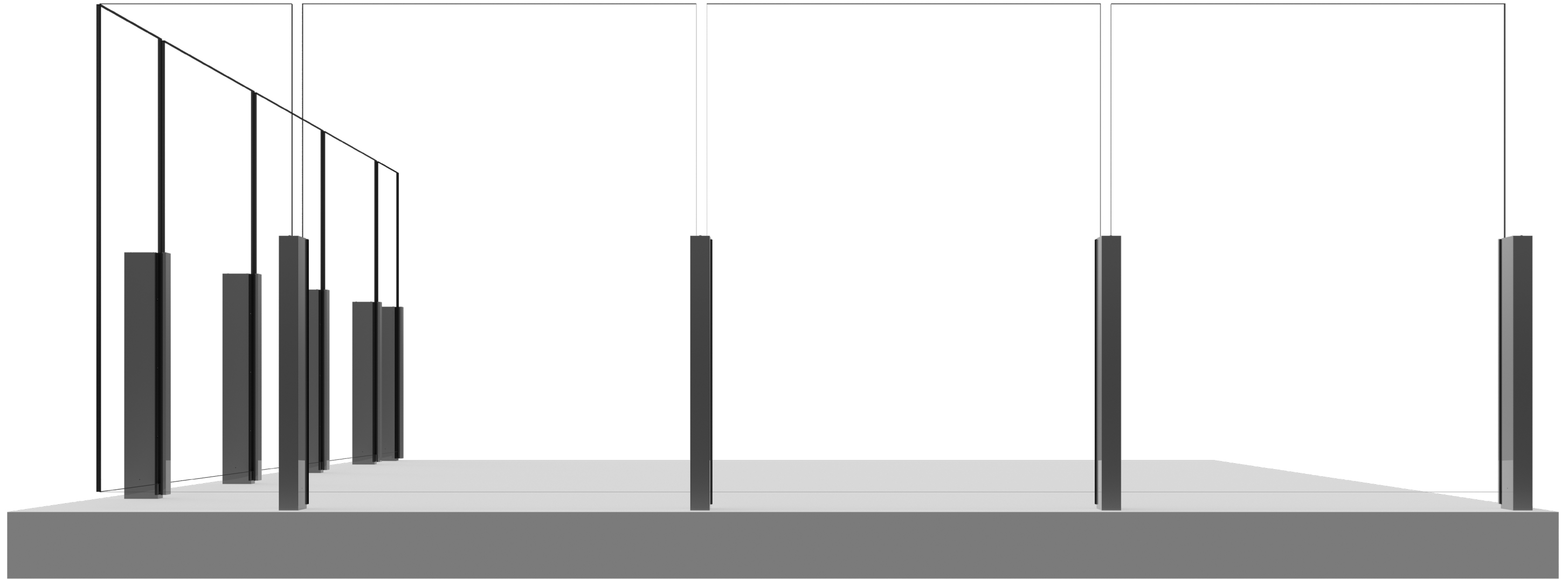

# ALUM. WINDWALL GLASS SCREEN SYSTEM

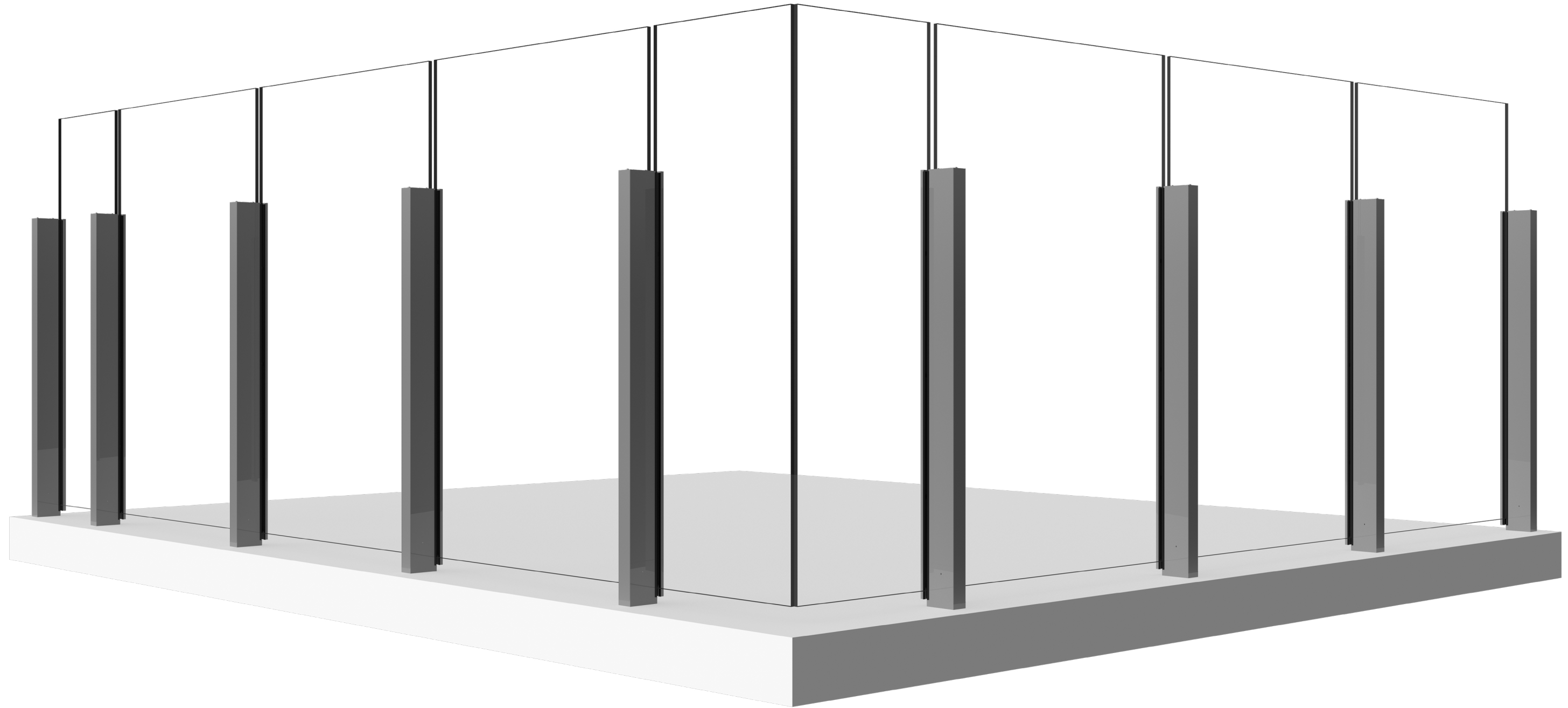

# ALUM. WINDWALL GLASS SCREEN SYSTEM

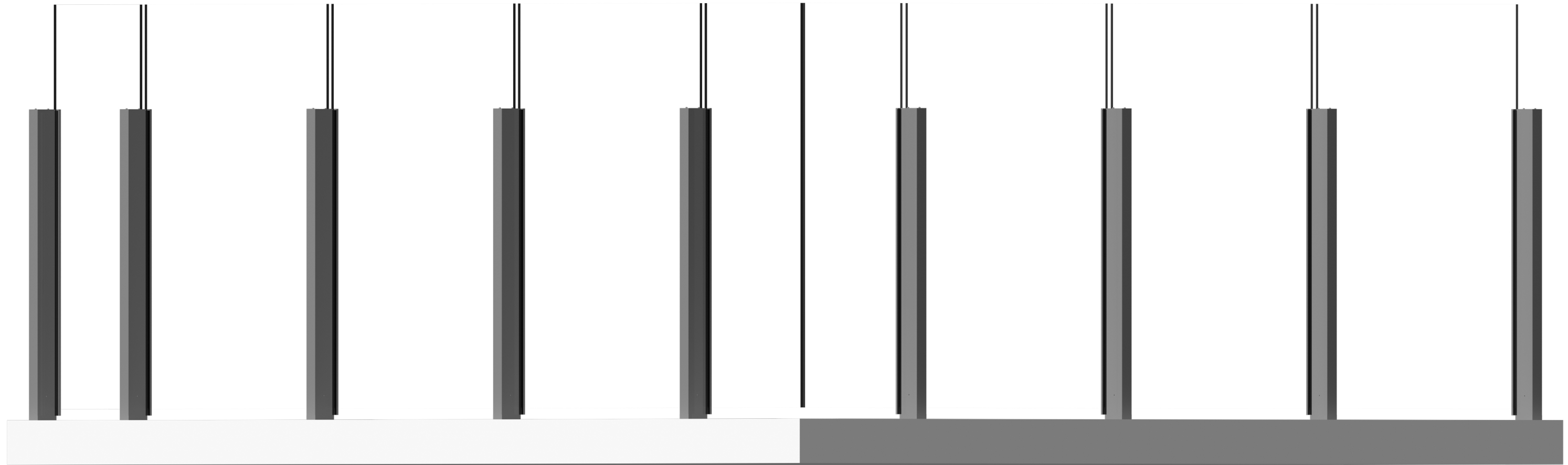

## NORTH AMERICA OPERATIONS



**DESIGN + ENGINEER + FABRICATE + INSTALL**

**151 W. Vista Ridge Mall Dr. Lewisville, TX 75067**

(Dallas/Fort Worth Metroplex)

PH: 972.353.8482 | [info@vivarailings.com](mailto:info@vivarailings.com)

[vivarailings.com](http://vivarailings.com)

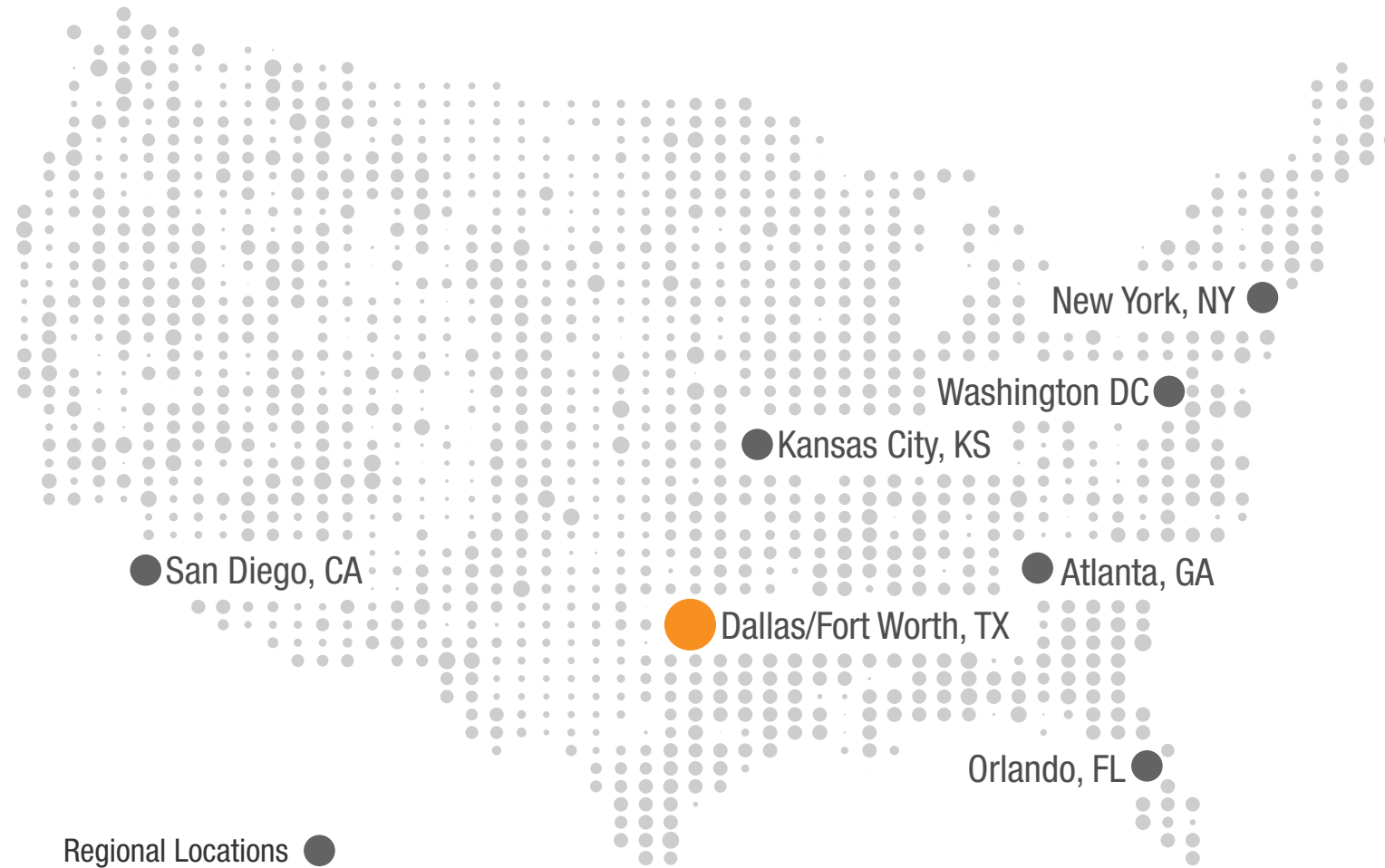

Regional Locations ●



Inc. Magazine 500 | 5000  
VIVA RAILINGS, LLC.  
Among The Fastest Growing  
US Companies  
Eight Years in a Row  
**2012-2019**

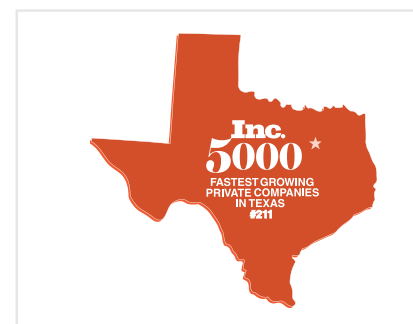

Inc. Magazine 500 | 5000  
VIVA RAILINGS, LLC.  
Among The Fastest Growing  
Texas Companies  
**#211**



ICC-ES 4405 Certified  
**SHOE™**  
Structural Glass Railing System

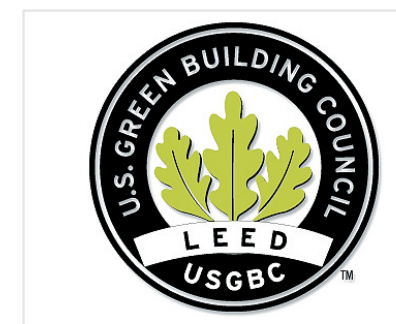

LEED  
Material & Resources Credits 4.1 and 4.2



The American Institute of Architects



The California Contractors State License  
Board Certified